

# ER COLLETS- ER 8, ER 11 & ER 16

## ER COLLETS

AccuCollets™ Precision and UltraPrecision Collets DIN 6499-form B (ER) set new standards of accuracy.

Precision Collets concentricity is 15 microns or 0.0005" TIR or better.

Ultra Precision Collets is 6 microns or 0.0002" TIR or better.

**Accu-Collets**

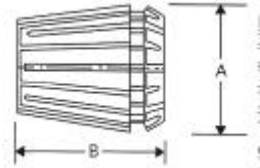

ER COLLET DIMENSIONS

Collet Series	A	B
ER 8	8.5mm (.335 in)	13.5mm (.531 in)
ER 11	11.5mm (.453 in)	18mm (.709 in)
ER 16	17mm (.669 in)	27mm (1.063 in)
ER 20	21mm (.827 in)	31mm (1.220 in)
ER 25	26mm (1.024 in)	35mm (1.378 in)
ER 32	33mm (1.299 in)	40mm (1.575 in)
ER 40	41mm (1.614 in)	46mm (1.811 in)

**Fractional Collets Manufactured Specifically To US Market Requirements! Metric Sizes Also Available. Use "On Size" Collet For Best Results!**

**FEATURES:**

- Manufactured with Swiss technology, expertise and machinery in collaboration with a Swiss company
- 16 jaw, high quality alloy steel construction
- Fractional Collets manufactured specifically for US market requirements
- Improved accuracy, higher precision
- Tighter tolerances and better surface finishes result in improved quality
- Longer tool life due to less vibration, better finish and higher accuracy



Collapse For ER-16 Collets is .04" For Bore Sizes Above 1.5mm

					ER-8		ER-11		ER-16	
ON SIZE		Nominal Size			Precision	Ultra Precision	Precision	Ultra Precision	Precision	Ultra Precision
Frac	MM	Dec.	Range	Nominal Sizes Covered	\$11.50 ea	\$14.50 ea	\$11.50 ea	\$15.00 ea	\$11.50 ea	\$15.00 ea
-	1.0	0.039	0.039-0.019	-	08-0039-1.0	08-0039-1.0UP	11-0039-1.0	11-0039-1.0UP	16-0039-1.0	16-0039-1.0UP
3/64	-	0.046	0.046-0.026	3/64	08-0046-3/64	08-0046-3/64UP	11-0046-3/64	11-0046-3/64UP	16-0046-3/64	16-0046-3/64UP
-	1.5	0.059	0.059-0.039	3/64	08-0059-1.5	08-0059-1.5UP	11-0059-1.5	11-0059-1.5UP	16-0059-1.5	16-0059-1.5UP
1/16	-	0.062	0.062-0.042	1/16, 3/64	08-0062-1/16	08-0062-1/16UP	11-0062-1/16	11-0062-1/16UP	16-0062-1/16	16-0062-1/16UP
5/64	-	0.078	0.078-0.058	5/64, 1/16	08-0078-5/64	08-0078-5/64UP	11-0078-5/64	11-0078-5/64UP	16-0078-5/64	16-0078-5/64UP
-	2.0	0.079	0.079-0.059	5/64, 1/16	08-0079-2.0	08-0079-2.0UP	11-0079-2.0	11-0079-2.0UP	16-0079-2.0	16-0079-2.0UP
3/32	-	0.093	0.093-0.073	3/32, 5/64	08-0093-3/32	08-0093-3/32UP	11-0093-3/32	11-0093-3/32UP	16-0093-3/32	16-0093-3/32UP
-	2.5	0.098	0.098-0.078	3/32	08-0098-2.5	08-0098-2.5UP	11-0098-2.5	11-0098-2.5UP	16-0098-2.5	16-0098-2.5UP
7/64	-	0.109	0.109-0.089	7/64, 3/32	08-0109-7/64	08-0109-7/64UP	11-0109-7/64	11-0109-7/64UP	16-0109-7/64	16-0109-7/64UP
-	3.0	0.118	0.118-0.098	7/64	08-0118-3.0	08-0118-3.0UP	11-0118-3.0	11-0118-3.0UP	16-0118-3.0	16-0118-3.0UP
1/8	-	0.125	0.125-0.105	1/8, 7/64	08-0125-1/8	08-0125-1/8UP	11-0125-1/8	11-0125-1/8UP	16-0125-1/8	16-0125-1/8UP
-	3.5	0.138	0.138-0.118	1/8	08-0138-3.5	08-0138-3.5UP	11-0138-3.5	11-0138-3.5UP	16-0138-3.5	16-0138-3.5UP
9/64	-	0.140	0.140-0.120	9/64, 1/8	08-0140-9/64	08-0140-9/64UP	11-0140-9/64	11-0140-9/64UP	16-0140-9/64	16-0140-9/64UP
5/32	-	0.156	0.156-0.136	5/32, 9/64	08-0156-5/32	08-0156-5/32UP	11-0156-5/32	11-0156-5/32UP	16-0156-5/32	16-0156-5/32UP
-	4.0	0.157	0.157-0.137	5/32, 9/64	08-0157-4.0	08-0157-4.0UP	11-0157-4.0	11-0157-4.0UP	16-0157-4.0	16-0157-4.0UP
11/64	-	0.171	0.171-0.151	11/64, 5/32	08-0171-11/64	08-0171-11/64UP	11-0171-11/64	11-0171-11/64UP	16-0171-11/64	16-0171-11/64UP
-	4.5	0.177	0.177-0.157	11/64	08-0177-4.5	08-0177-4.5UP	11-0177-4.5	11-0177-4.5UP	16-0177-4.5	16-0177-4.5UP
3/16	-	0.187	0.187-0.167	3/16, 11/64	08-0187-3/16	08-0187-3/16UP	11-0187-3/16	11-0187-3/16UP	16-0187-3/16	16-0187-3/16UP
-	5.0	0.196	0.196-0.176	3/16	08-0196-5.0	08-0196-5.0UP	11-0196-5.0	11-0196-5.0UP	16-0196-5.0	16-0196-5.0UP
13/64	-	0.203	0.203-0.183	13/64, 3/16	-	-	11-0203-13/64	11-0203-13/64UP	16-0203-13/64	16-0203-13/64UP
-	5.5	0.217	0.217-0.197	13/64	-	-	11-0217-5.5	11-0217-5.5UP	16-0217-5.5	16-0217-5.5UP
7/32	-	0.218	0.218-0.198	7/32, 13/64	-	-	11-0218-7/32	11-0218-7/32UP	16-0218-7/32	16-0218-7/32UP
15/64	-	0.234	0.234-0.214	15/64, 7/32	-	-	11-0234-15/64	11-0234-15/64UP	16-0234-15/64	16-0234-15/64UP
-	6.0	0.236	0.236-0.216	15/64, 7/32	-	-	11-0236-6.0	11-0236-6.0UP	16-0236-6.0	16-0236-6.0UP
1/4	-	0.250	0.250-0.230	1/4, 15/64	-	-	11-0250-1/4	11-0250-1/4UP	16-0250-1/4	16-0250-1/4UP
-	6.5	0.256	0.256-0.236	1/4	-	-	11-0256-6.5	11-0256-6.5UP	16-0256-6.5	16-0256-6.5UP
17/64	-	0.265	0.265-0.245	17/64, 1/4	-	-	11-0265-17/64	11-0265-17/64UP	16-0265-17/64	16-0265-17/64UP
-	7.0	0.275	0.275-0.255	17/64	-	-	11-0275-7.0	11-0275-7.0UP	16-0275-7.0	16-0275-7.0UP
9/32	-	0.281	0.281-0.242	9/32, 17/64	-	-	-	-	16-0281-9/32	16-0281-9/32UP
-	7.5	0.295	0.295-0.256	9/32, 17/64	-	-	-	-	16-0295-7.5	16-0295-7.5UP
19/64	-	0.296	0.296-0.257	19/64, 9/32	-	-	-	-	16-0296-19/64	16-0296-19/64UP
5/16	-	0.312	0.312-0.273	5/16, 19/64, 9/32	-	-	-	-	16-0312-5/16	16-0312-5/16UP
-	8	0.315	0.315-0.276	5/16, 19/64	-	-	-	-	16-0315-8.0	16-0315-8.0UP
21/64	-	0.328	0.328-0.289	21/64, 5/16, 19/64	-	-	-	-	16-0328-21/64	16-0328-21/64UP
-	8.5	0.335	0.334-0.295	21/64, 5/16	-	-	-	-	16-0334-8.5	16-0334-8.5UP
11/32	-	0.343	0.343-0.304	11/32, 21/64	-	-	-	-	16-0343-11/32	16-0343-11/32UP
-	9	0.354	0.354-0.315	11/32, 21/64	-	-	-	-	16-0354-9.0	16-0354-9.0UP
23/64	-	0.359	0.359-0.320	23/64, 11/32	-	-	-	-	16-0359-23/64	16-0359-23/64UP
-	9.5	0.374	0.374-0.335	23/64, 11/32	-	-	-	-	16-0374-9.5	16-0374-9.5UP
3/8	-	0.375	0.375-0.336	3/8, 23/64	-	-	-	-	16-0375-3/8	16-0375-3/8UP
25/64	-	0.390	0.390-0.351	25/64, 3/8, 23/64	-	-	-	-	16-0390-25/64	16-0390-25/64UP
-	10	0.394	0.393-0.354	25/64, 3/8	-	-	-	-	16-0393-10.0	16-0393-10.0UP

**Call Us Today For All Of Your Machine Tool Needs!**

## ER COLLETS

Accu-Collets

### FEATURES:

- Manufactured with Swiss technology, expertise and machinery in collaboration with a Swiss company
- 16 jaw, high quality alloy steel construction
- Fractional Collets manufactured specifically for US market requirements
- Improved accuracy, higher precision
- Tighter tolerances and better surface finishes result in improved quality
- Longer tool life due to less vibration, better finish and higher accuracy



Fractional Collets Manufactured Specifically  
To US Market Requirements!  
Use "On Size" Collet For Best Results!

Accu-Collets  
"Ultra Precision" Collets  
Are Genuine DIN 6499  
Standard Collets!

ON SIZE		Nominal Size			ER 20		ER 25	
Frac	MM	Dec.	Inch Range	Nominal Sizes Covered	Precision \$12.75 ea	UltraPrecision \$15.00 ea	Precision \$12.75 ea	UltraPrecision \$15.50 ea
-	1.0	0.039	0.039-0.019	13/32	20-0039-1.0	20-0039-1.0UP	-	-
1/16	-	0.062	0.062-0.042	1/16, 3/64	20-0062-1/16	20-0062-1/16UP	25-0062-1/16	-
-	2.0	0.079	0.079-0.040	5/64, 1/16	20-0079-2.0	20-0079-2.0UP	25-0079-2.0	25-0079-2.0UP
3/32	-	0.093	0.093-0.054	3/32, 5/64, 1/16	20-0093-3/32	20-0093-3/32UP	25-0093-3/32	25-0093-3/32UP
-	3.0	0.118	0.118-0.079	7/64, 3/32	20-0118-3.0	20-0118-3.0UP	25-0118-3.0	25-0118-3.0UP
1/8	-	0.125	0.125-0.086	1/8, 7/64	20-0125-1/8	20-0125-1/8UP	25-0125-01/8	25-0125-01/8UP
5/32	-	0.156	0.156-0.117	5/32, 9/64, 1/8	20-0156-5/32	20-0156-5/32UP	25-0156-5/32	25-0156-5/32UP
-	4.0	0.157	0.157-0.118	5/32, 9/64	20-0157-4.0	20-0157-4.0UP	25-0157-4.0	25-0157-4.0UP
3/16	-	0.187	0.187-0.148	3/16, 11/64	20-0187-3/16	20-0187-3/16UP	25-0187-3/16	25-0187-3/16UP
-	5.0	0.196	0.196-0.157	3/16, 11/64	20-0196-5.0	20-0196-5.0UP	25-0196-5.0	25-0196-5.0UP
7/32	-	0.218	0.218-0.179	7/32, 13/64	20-0218-7/32	20-0218-7/32UP	25-0218-7/32	25-0218-7/32UP
-	6.0	0.236	0.236-0.197	15/64, 7/32	20-0236-6.0	20-0236-6.0UP	25-0236-6.0	25-0236-6.0UP
1/4	-	0.250	0.250-0.211	1/4, 15/64, 7/32	20-0250-1/4	20-0250-1/4UP	25-0250-1/4	25-0250-1/4UP
-	7.0	0.275	0.275-0.236	17/64, 1/4	20-0275-7.0	20-0275-7.0UP	25-0275-7.0	25-0275-7.0UP
9/32	-	0.281	0.281-0.242	9/32, 17/64	20-0281-9/32	20-0281-9/32UP	25-0281-9/32	25-0281-9/32UP
5/16	-	0.312	0.312-0.273	5/16, 19/64, 9/32	20-0312-5/16	20-0312-5/16UP	25-0312-5/16	25-0312-5/16UP
-	8.0	0.315	0.315-0.276	5/16, 19/64	20-0315-8.0	20-0315-8.0UP	25-0315-8.0	25-0315-8.0UP
11/32	-	0.343	0.343-0.304	11/32, 21/64	20-0343-11/32	20-0343-11/32UP	25-0343-11/32	25-0343-11/32UP
-	9.0	0.354	0.354-0.315	11/32, 21/64	20-0354-9.0	20-0354-9.0UP	25-0354-9.0	25-0354-9.0UP
3/8	-	0.375	0.375-0.336	3/8, 23/64	20-0375-3/8	20-0375-3/8UP	25-0375-3/8	25-0375-3/8UP
-	10.0	0.393	0.393-0.354	25/64, 3/8	20-0393-10.0	20-0393-10.0UP	25-0393-10.0	25-0393-10.0UP
13/32	-	0.406	0.406-0.367	13/32, 25/64, 3/8	20-0406-13/32	20-0406-13/32UP	25-0406-13/32	25-0406-13/32UP
-	11.0	0.433	0.433-0.394	27/64, 13/32	20-0433-11.0	20-0433-11.0UP	25-0433-11.0	25-0433-11.0UP
7/16	-	0.437	0.437-0.398	7/16, 27/64	20-0437-7/16	20-0437-7/16UP	25-0437-7/16	25-0437-7/16UP
15/32	-	0.468	0.468-0.429	15/32, 29/64, 7/16	20-0468-15/32	20-0468-15/32UP	25-0468-15/32	25-0468-15/32UP
-	12.0	0.472	0.472-0.433	15/32, 29/64	20-0472-12.0	20-0472-12.0UP	25-0472-12.0	25-0472-12.0UP
1/2	-	0.500	0.500-0.461	1/2, 31/64	20-0500-1/2	20-0500-1/2UP	25-0500-1/2	25-0500-1/2UP
-	13.0	0.511	0.511-0.472	1/2, 31/64	20-0511-13.0	20-0511-13.0UP	25-0511-13.0	25-0511-13.0UP
17/32	-	0.531	0.531-0.492	17/32, 33/64	-	-	25-0531-17/32	25-0531-17/32UP
-	14	0.551	0.551-0.512	35/64, 17/32	-	-	25-0551-14.0	25-0551-14.0UP
9/16	-	0.563	0.562-0.523	9/16, 35/64, 17/32	-	-	25-0562-9/16	25-0562-9/16UP
-	15	0.591	0.590-0.551	37/64, 9/16	-	-	25-0590-15.0	25-0590-15.0UP
19/32	-	0.594	0.593-0.554	19/32, 37/64	-	-	25-0593-19/32	25-0593-19/32UP
5/8	-	0.625	0.625-0.586	5/8, 39/64, 19/32	-	-	25-0625-05/8	25-0625-05/8UP
-	16	0.630	0.630-0.591	5/8, 39/64	-	-	25-0630-16.0	25-0630-16.0UP

## ER COLLET SETS-METRIC

Inch Sets Also Available!  
See Page 167 for Our  
Complete Selection!



Accu-Collets

E



B

Type	No. of Collets	Part Number	Price	Type	No. of Collets	Range of Size	Part Number	Price
ER-8	9	08-SET9	\$103.50	ER-11	12	1-7mm	LY-E11-12S	\$358.68
ER-11	13	11-SET13	\$149.50	ER-16	9	1-10mm	LY-E16-9S	\$265.03
ER-16	10	16-SET10	\$115.00	ER-20	11	2-13mm	LY-E20-11S	\$318.01
ER-20	12	20-SET12	\$153.00	ER-25	14	2-16mm	LY-E25-14S	\$411.60
ER-25	15	25-SET15	\$191.25	ER-32	18	2-20mm	LY-E32-18S	\$551.25
ER-32	18	32-SET18	\$229.50	ER-40	23	3-26mm	LY-E40-23S	\$879.06
ER-40	23	40-SET23	\$368.00					

Call Us Or Visit Our Website For Our Complete Selection!

# ER COLLETS- ER 32 & ER 40

## ER COLLETS

**FEATURES:**

- Manufactured with Swiss technology, expertise and machinery in collaboration with a Swiss company
- 16 jaw, high quality alloy steel construction
- Fractional Collets manufactured specifically for US market requirements
- Improved accuracy, higher precision
- Tighter tolerances and better surface finishes result in improved quality
- Longer tool life due to less vibration, better finish and higher accuracy

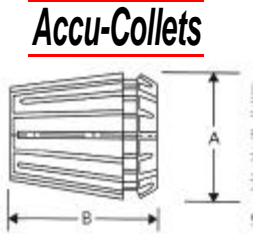

**ER COLLET DIMENSIONS**

Collet Series	A	B
ER 8	8.5mm (.335 in)	13.5mm (.531 in)
ER 11	11.5mm (.453 in)	18mm (.709 in)
ER 16	17mm (.669 in)	27mm (1.063 in)
ER 20	21mm (.827 in)	31mm (1.220 in)
ER 25	26mm (1.024 in)	35mm (1.378 in)
ER 32	33mm (1.299 in)	40mm (1.575 in)
ER 40	41mm (1.614 in)	46mm (1.811 in)

ON SIZE		Nominal Size			ER 32	
Frac	MM	Dec.	Inch Range	Nominal Sizes Covered	Precision \$12.75 ea	Ultra Precision \$16.75 ea
3/32	-	0.093	0.093-0.054	3/32, 5/64, 1/16	32-0093-3/32	32-0093-3/32UP
-	3.0	0.118	0.118-0.079	7/64, 3/32	32-0118-3.0	32-0118-3.0UP
1/8	-	0.125	0.125-0.086	1/8, 7/64	32-0125-1/8	32-0125-1/8UP
5/32	-	0.156	0.156-0.117	5/32, 9/64, 1/8	32-0156-5/32	32-0156-5/32UP
-	4.0	0.157	0.157-0.118	5/32, 9/64	32-0157-4.0	32-0157-4.0UP
3/16	-	0.187	0.187-0.148	3/16, 11/64	32-0187-3/16	32-0187-3/16UP
-	5.0	0.196	0.196-0.157	3/16, 11/64	32-0196-5.0	32-0196-5.0UP
7/32	-	0.218	0.218-0.179	7/32, 13/64	32-0218-7/32	32-0218-7/32UP
-	6.0	0.236	0.236-0.197	15/64, 7/32	32-0236-6.0	32-0236-6.0UP
1/4	-	0.250	0.250-0.211	1/4, 15/64, 7/32	32-0250-1/4	32-0250-1/4UP
-	7.0	0.275	0.275-0.236	17/64, 1/4	32-0275-7.0	32-0275-7.0UP
9/32	-	0.281	0.281-0.242	9/32, 17/64	32-0281-9/32	32-0281-9/32UP
5/16	-	0.312	0.312-0.273	5/16, 19/64, 9/32	32-0312-5/16	32-0312-5/16UP
-	8.0	0.315	0.315-0.276	5/16, 19/64	32-0315-8.0	32-0315-8.0UP
11/32	-	0.343	0.343-0.304	11/32, 21/64	32-0343-11/32	32-0343-11/32UP
-	9.0	0.354	0.354-0.315	11/32, 21/64	32-0354-9.0	32-0354-9.0UP
3/8	-	0.375	0.375-0.336	3/8, 23/64	32-0375-3/8	32-0375-3/8UP
-	10.0	0.393	0.393-0.354	25/64, 3/8	32-0393-10.0	32-0393-10.0UP
13/32	-	0.406	0.406-0.367	13/32, 25/64, 3/8	32-0406-13/32	32-0406-13/32UP
-	11.0	0.433	0.433-0.394	27/64, 13/32	32-0433-11.0	32-0433-11.0UP
7/16	-	0.437	0.437-0.398	7/16, 27/64	32-0437-7/16	32-0437-7/16UP
15/32	-	0.468	0.468-0.429	15/32, 29/64, 7/16	32-0468-15/32	32-0468-15/32UP
-	12.0	0.472	0.472-0.433	15/32, 29/64	32-0472-12.0	32-0472-12.0UP
1/2	-	0.500	0.500-0.461	1/2, 31/64	32-0500-1/2	32-0500-1/2UP
-	13.0	0.511	0.511-0.472	1/2, 31/64	32-0511-13.0	32-0511-13.0UP
17/32	-	0.531	0.531-0.492	17/32, 33/64	32-0531-17/32	32-0531-17/32UP
-	14	0.551	0.551-0.512	35/64, 17/32	32-0551-14.0	32-0551-14.0UP
9/16	-	0.563	0.562-0.523	9/16, 35/64, 17/32	32-0562-9/16	32-0562-9/16UP
-	15	0.591	0.590-0.551	37/64, 9/16	32-0590-15.0	32-0590-15.0UP
19/32	-	0.594	0.593-0.554	19/32, 37/64	32-0593-19/32	32-0593-19/32UP
5/8	-	0.625	0.625-0.586	5/8, 39/64, 19/32	32-0625-5/8	32-0625-5/8UP
-	16	0.630	0.630-0.591	5/8, 39/64	32-0630-16.0	32-0630-16.0UP
21/32	-	0.656	0.656-0.617	21/32, 41/64	32-0656-21/32	32-0656-21/32UP
-	17	0.670	0.669-0.630	21/32, 41/64	32-0669-17.0	32-0669-17.0UP
11/16	-	0.688	0.687-0.648	11/16, 43/64, 21/32	32-0687-11/16	32-0687-11/16UP
-	18	0.709	0.708-0.669	45/64, 11/16	32-0708-18.0	32-0708-18.0UP
23/32	-	0.719	0.718-0.679	23/32, 45/64	32-0718-23/32	32-0718-23/32UP
-	19	0.749	0.748-0.709	47/64, 23/32	32-0748-19.0	32-0748-19.0UP
3/4	-	0.750	0.750-0.711	3/4, 47/64	32-0750-3/4	32-0750-3/4UP
25/32	-	0.781	0.781-0.742	25/32, 49/64, 3/4	32-0781-25/32	32-0781-25/32UP
-	20	0.788	0.787-0.748	25/32, 49/64	32-0787-20.0	32-0787-20.0UP
13/16	-	0.813	0.813-0.783	13/16	32-0812-13/16	32-0812-13/16UP
-	21	0.827	0.826-0.787	13/16, 51/64	-	-
27/32	-	0.844	0.843-0.804	27/32, 53/64, 13/16	-	-
-	22	0.866	0.866-0.827	55/64, 27/32	-	-
7/8	-	0.875	0.875-0.836	7/8, 55/64	-	-
-	23	0.906	0.905-0.866	57/64, 7/8	-	-
29/32	-	0.906	0.906-0.867	29/32, 57/64	-	-
15/16	-	0.938	0.937-0.898	15/16, 59/64, 29/32	-	-
-	24	0.945	0.944-0.905	15/16, 59/64	-	-
31/32	-	0.969	0.968-0.929	31/32, 61/64	-	-
-	25	0.984	0.984-0.945	31/32, 61/64	-	-
1	-	1.000	1.000-0.961	1. 63/64, 31/32	-	-
1-1/64	-	1.016	1.016-0.976	1-1/64, 63/64	-	-
-	26	-	1.024-0.984	1-1/64	-	-

ER 40	
Precision \$16.00 ea	Ultra Precision \$21.00 ea
-	-
40-0125-1/8	40-0125-1/8UP
40-0156-5/32	40-0156-5/32UP
40-0157-4.0	40-0157-4.0UP
40-0187-3/16	40-0187-3/16UP
40-0196-5.0	40-0196-5.0UP
40-0218-7/32	40-0218-7/32UP
40-0236-6.0	40-0236-6.0UP
40-0250-1/4	40-0250-1/4UP
40-0275-7.0	40-0275-7.0UP
40-0281-9/32	40-0281-9/32UP
40-0312-5/16	40-0312-5/16UP
40-0315-8.0	40-0315-8.0UP
40-0343-11/32	40-0343-11/32UP
40-0354-9.0	40-0354-9.0UP
40-0375-3/8	40-0375-3/8UP
40-0393-10.0	40-0393-10.0UP
40-0406-13/32	40-0406-13/32UP
40-0433-11.0	40-0433-11.0UP
40-0437-7/16	40-0437-7/16UP
40-0468-15/32	40-0468-15/32UP
40-0472-12.0	40-0472-12.0UP
40-0500-1/2	40-0500-1/2UP
40-0511-13.0	40-0511-13.0UP
40-0531-17/32	40-0531-17/32UP
40-0551-14.0	40-0551-14.0UP
40-0562-9/16	40-0562-9/16UP
40-0590-15.0	40-0590-15.0UP
40-0593-19/32	40-0593-19/32UP
40-0625-5/8	40-0625-5/8UP
40-0630-16.0	40-0630-16.0UP
40-0656-21/32	40-0656-21/32UP
40-0669-17.0	40-0669-17.0UP
40-0687-11/16	40-0687-11/16UP
40-0708-18.0	40-0708-18.0UP
40-0718-23/32	40-0718-23/32UP
40-0748-19.0	40-0748-19.0UP
40-0750-3/4	40-0750-3/4UP
40-0781-25/32	40-0781-25/32UP
40-0787-20.0	40-0787-20.0UP
40-0812-13/16	40-0812-13/16UP
40-0826-21.0	40-0826-21.0UP
40-0843-27/32	40-0843-27/32UP
40-0866-22.0	40-0866-22.0UP
40-0875-7/8	40-0875-7/8UP
40-0905-23.0	40-0905-23.0UP
40-0906-29/32	40-0906-29/32UP
40-0937-15/16	40-0937-15/16UP
40-0944-24.0	40-0944-24.0UP
40-0968-31/32	40-0968-31/32UP
40-0984-25.0	40-0984-25.0UP
40-1000-1-IN	40-1000-1-INUP
40-1016-1-164	40-1016-1-164UP
40-1024-26.0	40-1024-26.0UP

**Call Us Today For All Of Your Machine Tool Needs!**

# ER COLLET SETS/COOLANT COLLETS

## ER COLLET SETS INCH & METRIC SIZES

Fractional Collets Manufactured Specifically  
To US Market Requirements!  
Use "On Size" Collet For Best Results!



Type	Style	Description	No. Of Collets	Part Number	Set Price
ER-8	Metric	1mm to 5mm x .5mm	9	08-SET9	\$103.50
	Inch	1/16"-3/16" x 1/64	9	08-SET9-INCH	\$103.50
ER-11	Metric	1mm to 7mm x .5mm	13	11-SET13	\$149.50
	Inch	1/16"-1/4" x 1/32	7	11-SET7-INCH	\$80.50
	Inch	1/16" - 1/4" x 1/64	13	11-SET13-INCH	\$149.50
ER-16	Metric	1mm to 10mm x 1mm	10	16-SET10	\$115.00
	Inch	1/16" - 3/8" x 1/32"	11	16-SET11-INCH	\$126.50
ER-20	Metric	1mm to 13mm x 1mm	12	20-SET12	\$153.00
	Inch	1/16" - 1/2" x 1/32"	15	20-SET15-INCH	\$191.25
ER-25	Metric	2mm to 16mm x 1mm	15	25-SET15	\$191.25
	Inch	1/16" - 5/8" x 1/32"	18	25-SET18-INCH	\$229.50
ER-32	Metric	3mm to 20mm x 1mm	18	32-SET18	\$229.50
	Inch	1/8"-3/4" x 1/32"	21	32-SET21-INCH	\$267.75
ER-40	Metric	4mm to 26mm x 1mm	23	40-SET23	\$368.00
	Inch	1/8"-1" x 1/64"	15	40-SET15-INCH	\$244.00
	Inch	1/8" - 1" x 1/32"	29	40-SET29-INCH	\$464.00

AccuCollets™ Precision Collets DIN 6499-form B (ER) set new standards of accuracy. Precision Collets concentricity is 15 microns or 0.0005" TIR or better.

- ER, TG, DA, AF, Coolant & Tap Collets Also Available
- Inch & Metric Sizes
- Straight Shank and V-flange Collet Holders Available.



## COLLET TRAYS

- High impact plastic tray will not damage accurate locating surfaces
- Sliding see thru plastic cover
- Up to 40 collets per tray - holds a full set plus special & metric sizes
- Angled seat location to secure collet
- Made in USA



Collet Series	Collet Capacity	Part Number	Price Each
ER-11	40	SIE-SAER-11-40	\$33.01
ER-16	40	SIE-SAER-16-40	\$33.01
ER-20	40	SIE-SAER-20-40	\$35.86
ER-25	40	SIE-SAER-25-40	\$35.86
ER-32	40	SIE-SAER-32-40	\$37.00
ER-40	28	SIE-SAER-40-28	\$37.00

Protect & Organize Your Collets!

## ER INCH & METRIC COOLANT COLLETS

### FEATURES:

- Unique patented design is solid steel construction ensuring longer life.
- No discs, plugs or other hardware needed.
- No rubber or silicone to wear out.
- Maximum pressure of 1000 psi.
- Drill insertion does not need to be longer than the collet length.
- Lyndex coolant style ER collets feature a unique patented design which staggers the slots to prevent coolant from reaching the face of the collet.



Note: ER coolant collets are designed for use with cylindrical shank tools (no flats). Use of coolant collets with tools that are not cylindrical will result in coolant leakage.

Nominal I.D. (OD)		L		Max. Runout	
mm	Inch	mm	Inch	mm	Inch
4 - 6	.1575"-.2362"	16	.6299"	0.010	.0004"
6 - 10	.2362"-.3937"	25	.9842"		
10 - 18	.3937"-.7086"	40	1.5748"	0.015	.0006"
18 - 26	.7086"-1.0236"	50	1.9685"		

Frac	MM	Dec.	ER 11 Coolant Collets		ER 16 Coolant Collets	
			Accu-Collets	Lyndex	Accu-Collets	Lyndex
-	3.0	0.1180	\$22.05 ea	\$47.00 ea	\$23.28 ea	\$47.00 ea
1/8	-	0.1250	11-0118-3.0C	11-0118-3.0CL	16-0118-3.0C	16-0118-3.0CL
-	3.5	0.1380	11-0125-1/8C	11-0125-1/8CL	16-0125-1/8C	-
9/64	-	0.1400	11-0138-3.5C	11-0138-3.5CL	16-0138-3.5C	16-0138-3.5CL
5/32	-	0.1560	11-0140-9/64C	11-0140-9/64CL	16-0140-9/64C	-
-	4.0	0.1570	11-0156-5/32C	11-0156-5/32CL	16-0156-5/32C	-
11/64	-	0.1710	11-0157-4.0C	11-0157-4.0CL	16-0157-4.0C	16-0157-4.0CL
-	4.5	0.1770	11-0171-11/64C	11-0171-11/64CL	16-0171-11/64C	-
3/16	-	0.1870	11-0177-4.5C	11-0177-4.5CL	16-0177-4.5C	16-0177-4.5CL
-	5.0	0.1960	11-0187-3/16C	11-0187-3/16CL	16-0187-3/16C	16-0187-3/16CL
13/64	-	0.2030	11-0196-5.0C	11-0196-5.0CL	16-0196-5.0C	16-0196-5.0CL
-	5.5	0.2170	11-0203-13/64C	11-0203-13/64CL	16-0203-13/64C	16-0203-13/64CL
7/32	-	0.2180	11-0217-5.5C	11-0217-5.5CL	16-0217-5.5C	16-0217-5.5CL
15/64	-	0.2340	11-0218-7/32C	11-0218-7/32CL	16-0218-7/32C	16-0218-7/32CL
-	6.0	0.2360	11-0234-15/64C	11-0234-15/64CL	16-0234-15/64C	16-0234-15/64CL
1/4	-	0.2500	11-0236-6.0C	11-0236-6.0CL	16-0236-6.0C	16-0236-6.0CL
-	6.5	0.2560	11-0250-1/4C	11-0250-1/4CL	16-0250-1/4C	16-0250-1/4CL
17/64	-	0.2650	11-0256-6.5C	11-0256-6.5CL	16-0256-6.5C	16-0256-6.5CL
-	7.0	0.2750	11-0265-17/64C	11-0265-17/64CL	16-0265-17/64C	16-0265-17/64CL
9/32	-	0.2812	11-0275-7.0C	11-0275-7.0CL	16-0275-7.0C	16-0275-7.0CL
-	7.5	0.2953	-	-	16-0281-9/32C	16-0281-9/32CL
19/64	-	0.2969	-	-	16-0295-7.5C	16-0295-7.5CL
5/16	-	0.3125	-	-	16-0296-19/64C	16-0296-19/64CL
-	8.0	0.3150	-	-	16-0312-5/16C	16-0312-5/16CL
21/64	-	0.3281	-	-	16-0315-8.0C	16-0315-8.0CL
-	8.5	0.3346	-	-	16-0328-21/64C	16-0328-21/64CL
11/32	-	0.3438	-	-	16-0334-8.5C	16-0334-8.5CL
-	9.0	0.3543	-	-	16-0343-11/32C	16-0343-11/32CL
23/64	-	0.3594	-	-	16-0354-9.0C	16-0354-9.0CL
-	9.5	0.3740	-	-	16-0359-23/64C	16-0359-23/64CL
3/8	-	0.3750	-	-	16-0374-9.5C	16-0374-9.5CL
25/64	-	0.3906	-	-	16-0375-3/8C	16-0375-3/8CL
-	10.0	0.3937	-	-	16-0390-25/64C	16-0390-25/64CL
			-	-	16-0393-10.0C	16-0393-10.0CL

Call Us Or Visit Our Website For Our Complete Selection!

# ER COOLANT COLLETS

## ER INCH & METRIC COOLANT COLLETS

### FEATURES:

- Unique patented design is solid steel construction ensuring longer life.
- No discs, plugs or other hardware needed.
- No rubber or silicone to wear out.
- Maximum pressure of 1000 psi.
- Drill insertion does not need to be longer than the collet length.
- Lyndex coolant style ER collets feature a unique patented design which staggers the slots to prevent coolant from reaching the face of the collet.



Accu-Collets



E

B

Note: ER coolant collets are designed for use with cylindrical shank tools (no flats). Use of coolant collets with tools that are not cylindrical will result in coolant leakage.

			ER 20 Coolant Collets		ER 25 Coolant Collets		ER 32 Coolant Collets		ER 40 Coolant Collets	
			Accu-Collets	Lyndex	Accu-Collets	Lyndex	Accu-Collets	Lyndex	Accu-Collets	Lyndex
Frac	MM	Dec.	\$24.01 ea	\$55.00 ea	\$25.03 ea	\$58.00 ea	\$25.76 ea	\$59.50 ea	\$28.21	\$67.50 ea
-	3.0	0.1180	20-0118-3.0C	20-0118-3.0CL	25-0118-3.0C	25-0118-3.0CL	32-0118-3.0C	32-0118-3.0CL	-	-
1/8	-	0.1250	20-0125-1/8C	-	25-0125-1/8C	-	32-0125-1/8C	-	-	-
5/32	-	0.1560	20-0156-5/32C	-	25-0156-5/32C	-	32-0156-5/32C	-	40-0156-5/32C	40-0156-5/32CL
-	4.0	0.1570	20-0157-4.0C	20-0157-4.0CL	25-0157-4.0C	25-0157-4.0CL	32-0157-4.0C	32-0157-4.0CL	40-0157-4.0C	40-0157-4.0CL
3/16	-	0.1870	20-0187-3/16C	20-0187-3/16CL	25-0187-3/16C	25-0187-3/16CL	32-0187-3/16C	32-0187-3/16CL	40-0187-3/16C	40-0187-3/16CL
-	5.0	0.1960	20-0196-5.0C	20-0196-5.0CL	25-0196-5.0C	25-0196-5.0CL	32-0196-5.0C	32-0196-5.0CL	40-0196-5.0C	40-0196-5.0CL
7/32	-	0.2180	20-0218-7/32C	20-0218-7/32CL	25-0218-7/32C	25-0218-7/32CL	32-0218-7/32C	32-0218-7/32CL	40-0218-7/32C	40-0218-7/32CL
-	6.0	0.2360	20-0236-6.0C	20-0236-6.0CL	25-0236-6.0C	25-0236-6.0CL	32-0236-6.0C	32-0236-6.0CL	40-0236-6.0C	40-0236-6.0CL
1/4	-	0.2500	20-0250-1/4C	20-0250-1/4CL	25-0250-1/4C	25-0250-1/4CL	32-0250-1/4C	32-0250-1/4CL	40-0250-1/4C	40-0250-1/4CL
-	7.0	0.2750	20-0275-7.0C	20-0275-7.0CL	25-0275-7.0C	25-0275-7.0CL	32-0275-7.0C	32-0275-7.0CL	40-0275-7.0C	40-0275-7.0CL
9/32	-	0.2810	20-0281-9/32C	20-0281-9/32CL	25-0281-9/32C	25-0281-9/32CL	32-0281-9/32C	32-0281-9/32CL	40-0281-9/32C	40-0281-9/32CL
5/16	-	0.3120	20-0312-5/16C	20-0312-5/16CL	25-0312-5/16C	25-0312-5/16CL	32-0312-5/16C	32-0312-5/16CL	40-0312-5/16C	40-0312-5/16CL
-	8.0	0.3150	20-0315-8.0C	20-0315-8.0CL	25-0315-8.0C	25-0315-8.0CL	32-0315-8.0C	32-0315-8.0CL	40-0315-8.0C	40-0315-8.0CL
11/32	-	0.3430	20-0343-11/32C	20-0343-11/32CL	25-0343-11/32C	25-0343-11/32CL	32-0343-11/32C	32-0343-11/32CL	40-0343-11/32C	40-0343-11/32CL
-	9.0	0.3540	20-0354-9.0C	20-0354-9.0CL	25-0354-9.0C	25-0354-9.0CL	32-0354-9.0C	32-0354-9.0CL	40-0354-9.0C	40-0354-9.0CL
3/8	-	0.3750	20-0375-3/8C	20-0375-3/8CL	25-0375-3/8C	25-0375-3/8CL	32-0375-3/8C	32-0375-3/8CL	40-0375-3/8C	40-0375-3/8CL
-	10.0	0.3930	20-0393-10.0C	20-0393-10.0CL	25-0393-10.0C	25-0393-10.0CL	32-0393-10.0C	32-0393-10.0CL	40-0393-10.0C	40-0393-10.0CL
13/32	-	0.4060	20-0406-13/32C	20-0406-13/32CL	25-0406-13/32C	25-0406-13/32CL	32-0406-13/32C	32-0406-13/32CL	40-0406-13/32C	40-0406-13/32CL
-	11.0	0.4330	20-0433-11.0C	20-0433-11.0CL	25-0433-11.0C	25-0433-11.0CL	32-0433-11.0C	32-0433-11.0CL	40-0433-11.0C	40-0433-11.0CL
7/16	-	0.4370	20-0437-7/16C	20-0437-7/16CL	25-0437-7/16C	25-0437-7/16CL	32-0437-7/16C	32-0437-7/16CL	40-0437-7/16C	40-0437-7/16CL
15/32	-	0.4680	20-0468-15/32C	20-0468-15/32CL	25-0468-15/32C	25-0468-15/32CL	32-0468-15/32C	32-0468-15/32CL	40-0468-15/32C	40-0468-15/32CL
-	12.0	0.4720	20-0472-12.0C	20-0472-12.0CL	25-0472-12.0C	25-0472-12.0CL	32-0472-12.0C	32-0472-12.0CL	40-0472-12.0C	40-0472-12.0CL
1/2	-	0.5000	20-0500-1/2C	20-0500-1/2CL	25-0500-1/2C	25-0500-1/2CL	32-0500-1/2C	32-0500-1/2CL	40-0500-1/2C	40-0500-1/2CL
-	13.0	0.5110	20-0511-13.0C	20-0511-13.0CL	25-0511-13.0C	25-0511-13.0CL	32-0511-13.0C	32-0511-13.0CL	40-0511-13.0C	40-0511-13.0CL
17/32	-	0.5310	-	-	25-0531-17/32C	25-0531-17/32CL	32-0531-17/32C	32-0531-17/32CL	40-0531-17/32C	40-0531-17/32CL
-	14.0	0.5510	-	-	25-0551-14.0C	25-0551-14.0CL	32-0551-14.0C	32-0551-14.0CL	40-0551-14.0C	40-0551-14.0CL
9/16	-	0.5620	-	-	25-0562-9/16C	25-0562-9/16CL	32-0562-9/16C	32-0562-9/16CL	40-0562-9/16C	40-0562-9/16CL
-	15.0	0.5900	-	-	25-0590-15.0C	25-0590-15.0CL	32-0590-15.0C	32-0590-15.0CL	40-0590-15.0C	40-0590-15.0CL
19/32	-	0.5930	-	-	25-0593-19/32C	25-0593-19/32CL	32-0593-19/32C	32-0593-19/32CL	40-0593-19/32C	40-0593-19/32CL
5/8	-	0.6250	-	-	25-0625-5/8C	25-0625-5/8CL	32-0625-5/8C	32-0625-5/8CL	40-0625-5/8C	40-0625-5/8CL
-	16.0	0.6300	-	-	25-0630-16.0C	25-0630-16.0CL	32-0630-16.0C	32-0630-16.0CL	40-0630-16.0C	40-0630-16.0CL
21/32	-	0.6560	-	-	-	-	32-0656-21/32C	32-0656-21/32CL	40-0656-21/32C	40-0656-21/32CL
-	17.0	0.6690	-	-	-	-	32-0669-17.0C	32-0669-17.0CL	40-0669-17.0C	40-0669-17.0CL
11/16	-	0.6870	-	-	-	-	32-0687-11/16C	32-0687-11/16CL	40-0687-11/16C	40-0687-11/16CL
-	18.0	0.7080	-	-	-	-	32-0708-18.0C	32-0708-18.0CL	40-0708-18.0C	40-0708-18.0CL
23/32	-	0.7180	-	-	-	-	32-0718-23/32C	32-0718-23/32CL	40-0718-23/32C	40-0718-23/32CL
-	19.0	0.7480	-	-	-	-	32-0748-19.0C	32-0748-19.0CL	40-0748-19.0C	40-0748-19.0CL
3/4	-	0.7500	-	-	-	-	32-0750-3/4C	32-0750-3/4CL	40-0750-3/4C	40-0750-3/4CL
25/32	-	0.7810	-	-	-	-	32-0781-25/32C	32-0781-25/32CL	40-0781-25/32C	40-0781-25/32CL
-	20.0	0.7870	-	-	-	-	32-0787-20.0C	32-0787-20.0CL	40-0787-20.0C	40-0787-20.0CL
13/16	-	0.8120	-	-	-	-	-	-	40-0812-13/16C	40-0812-13/16CL
-	21.0	0.8260	-	-	-	-	-	-	40-0826-21.0C	40-0826-21.0CL
27/32	-	0.8430	-	-	-	-	-	-	40-0843-27/32C	40-0843-27/32CL
-	22.0	0.8660	-	-	-	-	-	-	40-0866-22.0C	40-0866-22.0CL
7/8	-	0.8750	-	-	-	-	-	-	40-0875-7/8C	40-0875-7/8CL
-	23.0	0.9050	-	-	-	-	-	-	40-0905-23.0C	40-0905-23.0CL
29/32	-	0.9060	-	-	-	-	-	-	40-0906-29/32C	40-0906-29/32CL
15/16	-	0.9370	-	-	-	-	-	-	40-0937-15/16C	40-0937-15/16CL
-	24.0	0.9440	-	-	-	-	-	-	40-0944-24.0C	40-0944-24.0CL
31/32	-	0.9680	-	-	-	-	-	-	40-0968-31/32C	40-0968-31/32CL
-	25.0	0.9840	-	-	-	-	-	-	40-0984-25.0C	40-0984-25.0CL
1	-	1.0000	-	-	-	-	-	-	40-1000-1-INCL	40-1000-1-INCL
-	26.0	1.0236	-	-	-	-	-	-	40-1024-26.0C	40-1024-26.0CL

Call Us Today For All Of Your Machine Tool Needs!

# ER TAPPING COLLETS

## ER TAP COLLETS FOR RIGID TAPPING

These collets feature a unique design that incorporates an internal square drive with our popular ER series collets. The square drives match the tap square providing a tight fit for all rigid tapping applications. Utilizing ER tap collets and a standard ER collet chuck allows you to vary the gage length of your tapping application without the need for special tapholders.



**Accu-Collets**



**E**

**B**

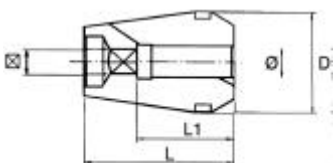

	ER-16	ER-20	ER-25
D	16.0mm	20.0mm	25.0mm
L	27.5mm	31.5mm	34.0mm

	ER-32	ER-40
D	32.0mm	40.0mm
L	40.0mm	46.0mm

ANSI Standard			ER 11	ER 16 Tap Collets		ER 20 Tap Collets	
Tap Size	Shank Size	Square Size	AccuCollets	AccuCollets	Lyndex	AccuCollets	Lyndex
#0 - 6	0.141	0.110	\$35.00 ea	\$37.00 ea	\$68.36 ea	\$39.00 ea	\$73.26 ea
#8	0.168	0.131	11-141-RA-AC	16-141-RA-AC	16-141-RA-LY	20-141-RA-AC	20-141-RA-LY
#10	0.194	0.152	11-118-RA-AC	16-168-RA-AC	16-168-RA-LY	20-168-RA-AC	20-168-RA-LY
			11-194-RA-AC	16-194-RA-AC	16-194-RA-LY	20-194-RA-AC	20-194-RA-LY
#12	0.220	0.165	11-220-RA-AC	16-220-RA-AC	16-220-RA-LY	20-220-RA-AC	20-220-RA-LY
1/4	0.255	0.191	11-255-RA-AC	16-255-RA-AC	16-255-RA-LY	20-255-RA-AC	20-255-RA-LY
5/16	0.318	0.238	-	16-318-RA-AC	-	20-318-RA-AC	20-318-RA-LY
3/8	0.381	0.286	-	-	-	20-381-RA-AC	20-381-RA-LY
7/16	0.323	0.242	-	-	-	20-323-RA-AC	20-323-RA-LY
1/2	0.367	0.275	-	-	-	20-367-RA-AC	20-367-RA-LY
9/16	0.429	0.322	-	-	-	-	-
5/8	0.480	0.360	-	-	-	-	-
11/16	0.542	0.406	-	-	-	-	-
3/4	0.590	0.442	-	-	-	-	-
13/16	0.652	0.489	-	-	-	-	-
7/8	0.697	0.523	-	-	-	-	-
15/16	0.760	0.570	-	-	-	-	-
1"	0.800	0.600	-	-	-	-	-

ANSI Standard			ER 25 Tap Collets		ER 32 Tap Collets		ER 40 Tap Collets	
Tap Size	Shank Size	Square Size	AccuCollets	Lyndex	AccuCollets	Lyndex	AccuCollets	Lyndex
#0 - 6	0.141	0.110	\$41.00 ea	\$75.46 ea	\$43.00 ea	\$77.42 ea	\$45.00 ea	\$95.80 ea
#8	0.168	0.131	25-141-RA-AC	25-141-RA-LY	32-141-RA-AC	32-141-RA-LY	40-141-RA-AC	40-141-RA-LY
#10	0.194	0.152	25-168-RA-AC	25-168-RA-LY	32-168-RA-AC	32-168-RA-LY	40-168-RA-AC	40-168-RA-LY
			25-194-RA-AC	25-194-RA-LY	32-194-RA-AC	32-194-RA-LY	40-194-RA-AC	40-194-RA-LY
#12	0.220	0.165	25-220-RA-AC	25-220-RA-LY	32-220-RA-AC	32-220-RA-LY	40-220-RA-AC	40-220-RA-LY
1/4	0.255	0.191	25-255-RA-AC	25-255-RA-LY	32-255-RA-AC	32-255-RA-LY	40-255-RA-AC	40-255-RA-LY
5/16	0.318	0.238	25-318-RA-AC	25-318-RA-LY	32-318-RA-AC	32-318-RA-LY	40-318-RA-AC	40-318-RA-LY
3/8	0.381	0.286	25-381-RA-AC	25-381-RA-LY	32-381-RA-AC	32-381-RA-LY	40-381-RA-AC	40-381-RA-LY
7/16	0.323	0.242	25-323-RA-AC	25-323-RA-LY	32-323-RA-AC	32-323-RA-LY	40-323-RA-AC	40-323-RA-LY
1/2	0.367	0.275	25-367-RA-AC	25-367-RA-LY	32-367-RA-AC	32-367-RA-LY	40-367-RA-AC	40-367-RA-LY
9/16	0.429	0.322	25-429-RA-AC	25-429-RA-LY	32-429-RA-AC	32-429-RA-LY	40-429-RA-AC	40-429-RA-LY
5/8	0.480	0.360	25-480-RA-AC	25-480-RA-LY	32-480-RA-AC	32-480-RA-LY	40-480-RA-AC	40-480-RA-LY
11/16	0.542	0.406	-	-	32-542-RA-AC	32-542-RA-LY	40-542-RA-AC	40-542-RA-LY
3/4	0.590	0.442	-	-	32-590-RA-AC	32-590-RA-LY	40-590-RA-AC	40-590-RA-LY
13/16	0.652	0.489	-	-	32-652-RA-AC	32-652-RA-LY	40-652-RA-AC	40-652-RA-LY
7/8	0.697	0.523	-	-	-	-	40-697-RA-AC	40-697-RA-LY
15/16	0.760	0.570	-	-	-	-	40-760-RA-AC	40-760-RA-LY
1"	0.800	0.600	-	-	-	-	40-800-RA-AC	40-800-RA-LY

## ER TAP COOLANT COLLETS FOR RIGID TAPPING



**Accu-Collets**



**E**

**B**

ANSI Standard			ER 16	ER 20 Tap Coolant Collets		ER 25 Tap Coolant Collets		ER 32 Tap Coolant Collets		ER 40 Tap Coolant Collets	
Tap Size	Shank Size	Square Size	Lyndex	AccuCollets	Lyndex	AccuCollets	Lyndex	AccuCollets	Lyndex	AccuCollets	Lyndex
#0-6	0.141	0.110	\$81.34 ea	\$66.50 ea	\$87.22 ea	\$68.40 ea	\$93.59 ea	\$70.30 ea	\$97.51 ea	\$76.00 ea	\$116.62 ea
#8	0.168	0.131	16-141-RAC-LY	-	20-141-RAC-LY	-	25-141-RAC-LY	32-141-RAC-AC	-	40-141-RAC-AC	-
#10	0.194	0.152	16-168-RAC-LY	-	20-168-RAC-LY	-	25-168-RAC-LY	32-168-RAC-AC	-	40-168-RAC-AC	-
			16-194-RAC-LY	-	20-194-RAC-LY	-	25-194-RAC-LY	32-194-RAC-AC	-	40-194-RAC-AC	-
#12	0.220	0.165	16-220-RAC-LY	-	20-220-RAC-LY	-	25-220-RAC-LY	32-220-RAC-AC	-	40-220-RAC-AC	-
1/4	0.255	0.191	16-255-RAC-LY	20-255-RAC-AC	20-255-RAC-LY	-	25-255-RAC-LY	32-255-RAC-AC	32-255-RAC-LY	40-255-RAC-AC	-
5/16	0.318	0.238	16-318-RAC-LY	20-318-RAC-AC	20-318-RAC-LY	25-318-RAC-AC	25-318-RAC-LY	32-318-RAC-AC	32-318-RAC-LY	40-318-RAC-AC	-
3/8	0.381	0.286	-	20-381-RAC-AC	20-381-RAC-LY	25-381-RAC-AC	25-381-RAC-LY	32-381-RAC-AC	32-381-RAC-LY	40-381-RAC-AC	40-381-RAC-LY
7/16	0.323	0.242	-	20-323-RAC-AC	20-323-RAC-LY	25-323-RAC-AC	25-323-RAC-LY	32-323-RAC-AC	32-323-RAC-LY	40-323-RAC-AC	40-323-RAC-LY
1/2	0.367	0.275	-	20-367-RAC-AC	20-367-RAC-LY	25-367-RAC-AC	25-367-RAC-LY	32-367-RAC-AC	32-367-RAC-LY	40-367-RAC-AC	40-367-RAC-LY
9/16	0.429	0.322	-	-	-	25-429-RAC-AC	25-429-RAC-LY	32-429-RAC-AC	32-429-RAC-LY	40-429-RAC-AC	40-429-RAC-LY
5/8	0.480	0.360	-	-	-	25-480-RAC-AC	25-480-RAC-LY	32-480-RAC-AC	32-480-RAC-LY	40-480-RAC-AC	40-480-RAC-LY
11/16	0.542	0.406	-	-	-	-	-	32-542-RAC-AC	32-542-RAC-LY	40-542-RAC-AC	40-542-RAC-LY
3/4	0.590	0.442	-	-	-	-	-	32-590-RAC-AC	32-590-RAC-LY	40-590-RAC-AC	40-590-RAC-LY
13/16	0.652	0.489	-	-	-	-	-	32-652-RAC-AC	32-652-RAC-LY	40-652-RAC-AC	40-652-RAC-LY
7/8	0.697	0.523	-	-	-	-	-	-	-	40-697-RAC-AC	40-697-RAC-LY
15/16	0.760	0.570	-	-	-	-	-	-	-	40-760-RAC-AC	40-760-RAC-LY
1"	0.800	0.600	-	-	-	-	-	-	-	40-800-RAC-AC	40-800-RAC-LY

Call Us Or Visit Our Website For Our Complete Selection!