

# ROUND JAWS- Metric Tongue & Groove

For Use On: SMW Autoblok KNCS, SMW Systems, Schunk, Rohm Chucks Using GBK Master Base Jaws

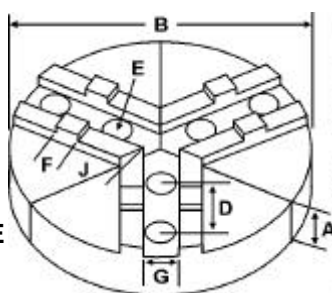
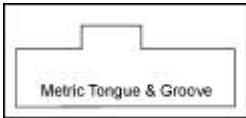

Group  
**TK**

## OFF CENTER TONGUE

- Round Jaws allow for complete gripping of workpiece.
- Oversized jaws available.
- Ideal for thin-walled or irregular shaped workpieces.
- Can be machined to fit workpiece.
- Available in Aluminum, Cast Iron & Steel.
- Made in the USA.

Group No.	Chuck Size	Critical Dimensions				Tongue to Front J	Pie Dia B	Hght Inch A	ALUMINUM		STEEL		
		Groove Width G	Tongue Width F	Screw Size E	Hole Space D				Part Number	Price Set Of 3	Part Number	Price Set Of 3	
TK-08-08-32	5 1/2 to 6	0.315 (8mm)	0.709	8mm	1.260 (32mm)	1.380	6	2.00	6-RWK-5200A	69.10	6-RWK-5200S	154.20	
								3.00	6-RWK-5300A	94.14	6-RWK-5300S	196.26	
								2.00	RWK-6200A	69.10	RWK-6200S	154.20	
								3.00	RWK-6300A	94.14	RWK-6300S	170.66	
TK-10-08-40	8	0.393 (10mm)	0.787	8mm	1.575 (40mm)	1.360	8	2.00	RWK-8200A	103.98	RWK-8200S	235.52	
								3.00	RWK-8300A	126.81	RWK-8300S	323.83	
								10	2.00	RWK-10200A	136.45	RWK-10200S	338.55
TK-12-12-40	10	0.472 (12mm)	0.787	12mm	1.575 (40mm)	2.050	10	3.00	RWK-10300A	160.00	RWK-10300S	441.59	
								10	4.00	RWK-10400A*	187.00	-	-
								12	3.00	12-RWK-10300A	247.00	-	-
								12	4.00	12-RWK-10400A	312.00	-	-
								15	2.50	15-RWK-10250A	366.98	-	-
								15	4.00	15-RWK-10400A*	448.37	-	-
								18	4.00	18-RWK-10400A*	674.80	-	-
TK-12-12-54	12 to 16	0.472 (12mm)	1.023	12mm	2.126 (54mm)	2.950	12	2.00	RWK-12200A	177.32	RWK-12200S*	441.59	
								3.00	RWK-12300A	247.00	RWK-12300S*	588.78	
								18	2.50	18-RWK-12250A*	499.54	-	-

Round Jaw Material: ALUMINUM-6061-T6 Bar Stock, CAST IRON-Gray, STEEL-1018, 18" & Larger- Aluminum Casting T6  
For complete list of applicable chucks, see pages 60-72. \* denotes non-stock item. Please allow 1 week manufacturing time.

## For Use On: Forkardt, Rohm & SMW Chucks

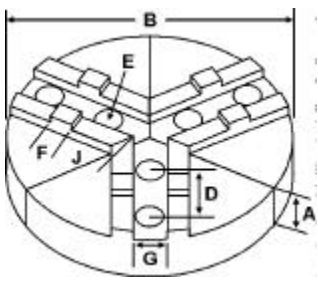

- Round Jaws allow for complete gripping of workpiece.
- Oversized jaws available.
- Ideal for thin-walled or irregular shaped workpieces.
- Can be machined to fit workpiece.
- Available in Aluminum, Cast Iron & Steel.
- Made in the USA.

Group No.	Chuck Size	Critical Dimensions				Tongue to Front J	Pie Dia B	Hght Inch A	ALUMINUM		STEEL	
		Groove Width G	Tongue Width F	Screw Size E	Hole Space D				Part Number	Price Set Of 3	Part Number	Price Set Of 3
TK-08-5/16-32	6	0.315 (8mm)	0.708	5/16	1.260 (32mm)	1.380	6	2.00	RSW-6200A	69.10	RSW-6200S	134.09
								3.00	RSW-6300A	94.14	RSW-6300S	170.66
TK-10-5/16-40	8	0.393 (10mm)	0.787	5/16	1.575 (40mm)	2.000	8	2.00	RSW-8200A	103.98	RSW-8200S	235.52
								3.00	RSW-8300A	126.81	RSW-8300S	323.83
								10	2.00	RSW-10200A	136.45	RSW-10200S
TK-12-1/2-40	10	0.472 (12mm)	0.787	1/2	1.575 (40mm)	2.400	10	3.00	RSW-10300A	197.88	RSW-10300S	365.70
								4.00	RSW-10400A*	226.12	-	-
								12	2.00	RSW-12200A	177.32	-
TK-12-1/2-54	12	0.472 (12mm)	1.023	1/2	2.126 (54mm)	2.950	12	3.00	RSW-12300A	292.45	-	-

Round Jaw Material: ALUMINUM-6061-T6 Bar Stock, CAST IRON-Gray, STEEL-1018  
For complete list of applicable chucks, see pages 60-72. \* denotes non-stock item. Please allow 1 week manufacturing time.

**Call Us Today For All Of Your Machine Tool Needs!**

# SOFT JAWS- Metric Tongue & Groove

For Use On: **SMW Autoblok KNCS, SMW Systems, Schunk, Rohm Chucks**  
Using **GBK Master Base Jaws**

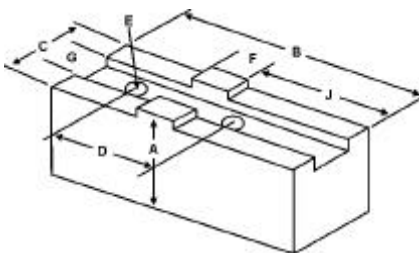

- Supplies maximum concentricity on finish turning operations.
- Can be bored or turned to fit workpiece.
- Steel jaws can be hardened.
- Available pointed for smaller diameter parts.
- Special orders available
- Available in Aluminum, Steel & Aircraft Aluminum.



Group



**QUANTITY DISCOUNTS!**  
Order **5 SETS OR MORE** of the same part number soft jaws and receive a **5% DISCOUNT!**

## CENTERED & OFFSET TONGUE



Group No.	Chuck Size	Critical Dimensions				NEW LOWER PRICES!					ALUMINUM		STEEL	
		Groove Width G	Tongue Width F	Screw Size E	Hole Space D	Tongue to Front J	Tongue Position	Width Inch C	Length Inch B	Hght Inch A	FLAT END Part Number	Price Set Of 3	FLAT END Part Number	Price Set Of 3
TK-08-08-32	5 1/2	0.315 (8mm)	0.709	8mm	1.260 (32mm)	1.380	Offset	0.750	2.750	1.50	WK-5150AF	35.58	WK-5150F	38.40
						0.895	Centered	1.500	2.500	1.50	WK-5152AF	53.42	WK-5152F	57.61
						1.380	Offset	0.750	2.750	1.50	WK-6150AF	35.58	WK-6150F	38.40
	6	0.315 (8mm)	0.709	8mm	1.260 (32mm)	0.895	Centered	1.500	2.500	1.50	WK-6152AF	53.42	WK-6152F	57.61
						1.380	Offset	0.750	2.750	2.00	WK-6200AF*	61.79	-	-
						1.670	Offset	0.750	3.375	1.50	WK-7150AF	41.53	WK-7150F	44.81
7	0.315 (8mm)	0.709	8mm	1.260 (32mm)	1.000	Offset	1.500	2.500	1.50	WK-7152AF	53.42	WK-7152F	57.61	
					1.920	Offset	1.000	4.125	2.00	WK-8200AF	53.57	WK-8200F	57.61	
TK-10-08-40	8	0.393 (10mm)	0.787	8mm	1.575 (40mm)	0.980	Centered	1.750	2.750	2.00	WK-8202AF	59.56	WK-8202F	64.00
TK-12-12-40	10	0.472 (12mm)	0.787	12mm	1.575 (40mm)	3.125	Offset	1.250	5.000	2.50	WK-10200AF	59.71	WK-10200F	64.00
						1.500	Offset	2.250	3.500	2.50	WK-10252AF	77.83	WK-10252F	83.21
TK-12-12-54	12 - 16	0.472 (12mm)	1.023	12mm	2.126 (54mm)	1.990	Centered	1.250	5.000	2.00	WK-12200AF	59.71	WK-12200F	64.00
						1.400	Offset	3.000	3.500	2.50	WK-12252AF	101.81	WK-12252F	108.81
						3.230	Offset	1.500	5.750	2.25	WK-16220AF	81.35	WK-16220F	87.04
						1.750	Offset	3.000	4.000	3.00	WK-16302AF	110.63	WK-16302F	117.78
TK-18-16-60	18 - 24	0.708 (18mm)	1.180	16mm	2.362 (60mm)	3.000	Offset	1.750	7.000	2.875	WK-24300AF*	85.76	-	-
						3.000	Offset	4.000	6.000	2.875	WK-24302AF*	221.24	-	-

For "Pointed" Soft Jaws, please substitute "P" for "F" in the part number. Example: WK-5150AF will be WK-5150AP. Pointed Jaws: Up to 10" add \$3.25, 12" & over add \$6.50.  
Soft Jaw Material: ALUMINUM-6061-T6 Bar Stock, STEEL-1018, "B" JAWS-7075-T6 Aircraft Aluminum

For complete list of applicable chucks, see pages 60-72. \* denotes non-stock item. Please allow 1 week manufacturing time.

## For Use On: Forkardt, Rohm & SMW Chucks

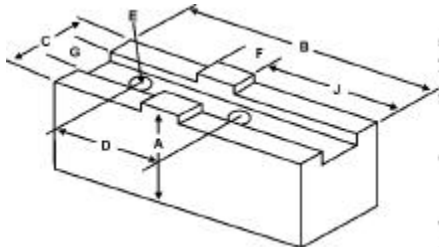

**QUANTITY DISCOUNTS!**  
Order **5 SETS OR MORE** of the same part number soft jaws and receive a **5% DISCOUNT!**



## OFF-CENTERED TONGUE

Group No.	Chuck Size	Critical Dimensions				Tongue to Front J	Tongue Position	Width Inch C	Length Inch B	Hght Inch A	ALUMINUM		STEEL	
		Groove Width G	Tongue Width F	Screw Size E	Hole Space D						FLAT END Part Number	Price Set Of 3	FLAT END Part Number	Price Set Of 3
TK-08-5/16-32	6	0.315 (8mm)	0.708	5/16	1.260 (32mm)	1.660	Offset	0.750	3.375	1.50	SW-6150AF	35.54	SW-6150F	38.28
										3.00	SW-6300AF	49.35	SW-6300F	53.00
TK-10-5/16-40	8	0.393 (10mm)	0.787	5/16	1.575 (40mm)	1.970	Offset	1.250	4.125	2.00	SW-8200AF	49.53	SW-8200F	53.00
										4.00	SW-8400AF	66.50	SW-8400F	70.66
TK-12-1/2-40	10	0.472 (12mm)	0.787	1/2	1.575 (40mm)	2.750	Offset	1.500	5.000	2.00	SW-10200AF	62.05	SW-10200F	66.25
										4.00	SW-10400AF	77.97	SW-10400F	82.43
TK-12-1/2-54	12	0.472 (12mm)	1.023	1/2	2.126 (54mm)	2.937	Offset	1.750	5.750	2.00	SW-12200AF	66.48	SW-12200F	70.66
										4.00	SW-12400AF	84.08	SW-12400F	88.32
TK-18-5/8-60	16	0.708 (18mm)	1.181	5/8	2.362 (60mm)	3.937	Offset	2.000	7.250	3.00	SW-16300AF	104.66	SW-16300F	110.41
										5.00	SW-16500AF	126.93	SW-16500F	132.48

For "Pointed" Soft Jaws, please substitute "P" for "F" in the part number. Example: SW-6150AF will be SW-6150AP. Pointed Jaws: Up to 10" add \$3.25, 12" & over add \$6.50.

Soft Jaw Material: ALUMINUM-6061-T6 Bar Stock, STEEL-1018, "B" JAWS-7075-T6 Aircraft Aluminum

For complete list of applicable chucks, see pages 60-72. \* denotes non-stock item. Please allow 1 week manufacturing time.

**Call Us Or Visit Our Website For Our Complete Selection!**