

JAW NUTS WITH & WITHOUT SCREWS-FOR 1.5mm X 60° CHUCKS

C

JAW NUTS

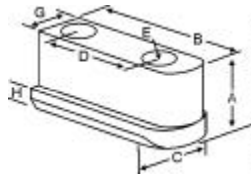

FEATURES:

- Made in USA Jaw Nuts are black oxidized to ensure long life.
- “-U” OEM Style Jaw Nuts are a High Quality Import
- Available with or without screws

Kitagawa	MMK Matsumoto	Chuck Size	CRITICAL DIMENSIONS							WITH SCREWS		WITHOUT SCREWS					
			Heel Height H	Groove Width G	Screw Size Pitch & Length E	Hole Space D	Hght Inch A	Width Inch C	Length Inch B	Jaw Nut Part Number	Price Each	Jawnut No Screws Part Number	Price Each				
B-04,BT-04,HOB-4	-	4	0.22	0.312 (8mm)	M6-1.00x25mm	0.59 (15mm)	0.531	0.453	0.965	KT-40JN	\$29.44	KT-40JN-NS	\$28.94				
B-04,BT-04,HOB-4	-									0.453	0.965	KT-40JN-U	\$25.13	KT-40JN-UNS	\$24.63		
NL-04,AS-04,AT-04, HJ-4,N-04,NT-04	H-4(HPC),HH-4 H4(NAK),H-4-21						0.551 (14mm)	0.71	0.59	1.03	KT-45JN	\$29.44	KT-45JN-NS	\$28.94			
HOBT-5,B-05, BT-05,HOB-5	-	5		0.392 (10mm)	M8-1.25x25mm	0.713 (18mm)	0.612	0.55	1.18	KT-53JN	\$29.44	KT-53JN-NS	\$28.94				
HJ-5,N-05,NT-05	-	4						0.748 (19mm)	0.612	0.55	1.18	KT-53JN-U	\$25.13	KT-53JN-UNS	\$24.63		
-	-	6		0.295	0.432 (11mm)	M10-1.60x30mm	0.787 (20mm)	0.847	0.669	1.46	HO-62JN	\$26.50	HO-62JN-NS	\$26.00			
-	Z-6,ZA5-6-0, ZA5-6B,ZJA5-6							0.984 (25mm)	0.79	0.69	1.57	SG-60JN	\$26.50	SG-60JN-NS	\$26.00		
B-206,BT-206, BB-06,B-07,B-106	-				0.472 (12mm)	M10-1.60x30mm	0.787 (20mm)	0.728	0.689	1.417	KT-60JN	\$26.50	KT-60JN-NS	\$26.00			
B-206,BT-206, BB-06,B-07,B-106	-								0.787 (20mm)	0.728	0.689	1.417	KT-60JN-U	\$24.14	KT-60JN-UNS	\$23.64	
B-06	-								0.885	0.689	1.44	KT-61JN	\$26.50	KT-61JN-NS	\$26.00		
-	-								0.885	0.689	1.44	KT-61JN-U	\$24.14	KT-61JN-UNS	\$23.64		
-	-	8	0.335	0.549 (14mm)	M12-1.75x35mm	0.984 (25mm)	0.895	0.807	1.84	KT-82JN	\$27.98	KT-82JN-NS	\$26.98				
BB-08,B-108, B-208,BT-208	-									0.807	0.807	1.88	KT-81JN	\$24.33	KT-81JN-NS	\$23.33	
NT-08,B-08, BT-08,HOB-8	-						1	0.807	1.88	KT-81JN-U	\$20.18	KT-81JN-UNS	\$19.18				
-	-						1	0.807	1.88	KT-80JN	\$19.51	KT-80JN-NS	\$18.51				
-	-						1	0.807	1.88	KT-80JN-U	\$20.18	KT-80JN-UNS	\$19.18				
HOWA: HO15M10,HO22 M10,HO24M10	-					0.629 (16mm)	M12-1.75x40mm	0.984 (25mm)	1.04	0.807	1.83	HO-80JN	\$27.98	HO-80JN-NS	\$26.98		
B-210, BT-210	H-10,HA 8-11, HH-10	10	0.335	0.628 (16mm)	M12-1.75x30mm	1.181 (30mm)	0.846	0.886	1.981	KT-100JN	\$23.84	KT-100JN-NS	\$22.84				
B-10, HOB-10	-									0.846	0.886	1.981	KT-100JN-U	\$18.69	KT-100JN-UNS	\$17.69	
-	For Hitachi-Seiki ZA/ZA_-10				0.374	0.628 (16mm)	M12-1.75x35mm	1.181 (30mm)	1	0.886	2.16	KT-101JN	\$29.44	KT-101JN-NS	\$28.44		
-	-						0.315	0.628 (16mm)	M12-1.75x35mm	1.25 (32mm)	0.9	0.905	2.05	MT-100JN	\$29.44	MT-100JN-NS	\$28.44
HOWA: HO15M12,HO22M12	-						0.374	0.708 (18mm)	M14-2.00x40mm	1.181 (30mm)	1.083	0.945	2.36	HO-100JN	\$29.44	HO-100JN-NS	\$28.44
-	-																
B-12, HOB-12	HH-12, HHL-12	12	0.531	0.708 (18mm)	M14-2.00x45mm	1.181 (30mm)	1.318	1.04	2.185	KT-120JN	\$30.85	KT-120JN-NS	\$29.85				
-	-								1.318	1.04	2.185	KT-120JN-U	\$28.11	KT-120JN-UNS	\$27.11		
-	-						1.488 (38mm)	1.318	1.04	2.185	KT-124JN	\$30.92	KT-124JN-NS	\$29.92			
-	-						0.787 (20mm)	M12-1.75x45mm	1.32	1.04	2.19	SG-120JN	\$35.56	SG-120JN-NS	\$34.56		
-	-						0.453	0.827 (21mm)	M16-2.00x40mm	1.181 (30mm)	1.09	1.16	2.565	KT-128JN	\$31.55	KT-128JN-NS	\$30.55
-	-										1.14	1.06	2.429	KT-128JN-U	\$28.11	KT-128JN-UNS	\$27.11
-	-	15	0.649	0.864 (22mm)	M20-2.50x55mm	1.69 (43mm)	1.79	1.318	3.149	KT-150JN	\$43.46	KT-150JN-NS	\$41.96				
-	-								2.36 (60mm)	1.79	1.32	3.82	KT-152JN	\$42.70	KT-152JN-NS	\$41.20	
B-215	-					1.003 (25.5mm)	M20-2.50x50mm	1.69 (43mm)	1.55	1.375	3.149	KT-151JN	\$43.46	KT-151JN-NS	\$41.96		
-	-									1.375	3.149	KT-151JN-U	\$38.36	KT-151JN-UNS	\$36.86		
B-15, B-450, BT-15, B-18, HOB-15	-					0.861 (22mm)	M20-2.50x50mm	1.69 (43mm)	1.779	1.317	3.149	KT-153JN	\$41.98	KT-153JN-NS	\$40.48		
-	-									1.317	3.149	KT-153JN-U	\$36.36	KT-153JN-UNS	\$34.86		
N18	-	15/18	0.73	1.003 (25.5mm)	M20-2.50x50mm	T-Nut	1.54	1.378	1.654	KT-180JN	\$43.16	KT-180JN-NS	\$41.66				
UVE-800LB	-	24	0.414	0.985 (25mm)	M20-2.50x50mm	3.152 (80mm)	1.241	1.418	4.728	KT-241JN	\$59.52	KT-241JN-NS	\$58.02				
HJ-24, HJA11-24	-			0.748	0.985 (25mm)	M20-2.50x50mm	3.152 (80mm)	2.127	1.576	4.728	KT-242JN	\$59.52	KT-242JN-NS	\$58.02			

Call Us Today For All Of Your Machine Tool Needs!