

# POWER CHUCKS

## B200 & BT200 SERIES POWER CHUCKS

**KITAGAWA**

3 & 2 Jaw wedge style power chucks deliver up to 20% more speed, gripping force and bore size when compared to conventional chucks. The B200 Series have the largest bores of any wedge style power chuck. This series delivers consistent accuracy and repetitive chucking. Kitagawa B200 & BT200 Series Chucks are manufactured from high grade alloy steel. All sliding surfaces are hardened and ground to assure consistent accuracy and performance.



### 3 JAW POWER CHUCKS: B204-B212 PRICING & SPECIFICATIONS

Model/Part Number	KIT-B204	KIT-B205	KIT-B206A05	KIT-B208A06	KIT-B210A06	KIT-B210A08	KIT-B212A06	KIT-B212A08
<b>Price</b>	<b>\$2,151.10</b>	<b>\$2,283.40</b>	<b>\$2,568.58</b>	<b>\$3,166.38</b>	<b>\$3,835.72</b>	<b>\$3,835.72</b>	<b>\$5,233.20</b>	<b>\$5,233.20</b>
Spindle Nose	3.346	4.331	A2-5	A2-6	A2-6	A2-8	A2-6	A2-8
Thru - Hole	in 1.024	1.299	1.772	2.047	2.953	2.953	3.583	3.583
Jaw Stroke (dia)	in 0.213	0.213	0.217	0.291	0.346	0.346	0.417	0.417
Plunger Stroke	in 0.394	0.394	0.472	0.63	0.748	0.748	0.906	0.906
Max Draw Bar Pull Force	lbs 3142	3590	4846	7808	9471	9471	12115	12115
Max Gripping Force	lbs 6393	8076	12555	19292	24449	24449	31718	31718
Max Speed	rpm 8000	7000	6000	5000	4200	4200	3300	3300
Net Weight	lbs 8.8	14.7	27.1	48.5	81.1	75.1	122.9	117
Accuracy - T.I.R.	0.0008	0.0008	0.0008	0.0008	0.0008	0.0008	0.0008	0.0008
Matching Cylinder	S1036	S1036	S1246	S1552	S1875	S1875	S2091	S2091
	-	-	\$3,340.00	\$3,450.00	\$4,500.00	\$4,500.00	\$5,400.00	\$5,400.00
Master Jaw	KIT-GB3499	KIT-GB3500	KIT-GB3501	KIT-GB3502	KIT-GB3503	KIT-GB3503	KIT-GB3504	KIT-GB3504
	\$976.00	\$1,005.00	\$1,106.00	\$1,315.00	\$1,470.00	\$1,470.00	\$1,880.00	\$1,880.00

### 2 JAW POWER CHUCKS: BT204-BT212 PRICING & SPECIFICATIONS

Model/Part Number	KIT-BT205	KIT-BT206A05	KIT-BT208A06	KIT-BT210A06	KIT-BT212A06	KIT-BT212A08
<b>Price</b>	<b>\$2,273.60</b>	<b>\$2,562.70</b>	<b>\$3,160.50</b>	<b>\$3,743.60</b>	<b>\$4,826.50</b>	<b>\$4,826.50</b>
Spindle Nose	4.331	A2-5	A2-6	A2-6	A2-6	A2-8
Thru - Hole	in 1.299	1.772	2.047	2.953	3.583	3.583
Jaw Stroke (dia)	in 0.213	0.217	0.291	0.346	0.417	0.417
Plunger Stroke	in 0.394	0.472	0.63	0.748	0.906	0.906
Max Draw Bar Pull Force	lbs 2625	3258	5053	6401	8242	8242
Max Gripping Force	lbs 5383	8535	12577	16621	21562	21562
Max Speed	rpm 7000	6000	4800	4200	3300	3300
Net Weight	lbs 14.3	26.7	45.4	76.2	112.1	106.2
Accuracy - T.I.R.	0.0008	0.0008	0.0008	0.0008	0.0008	0.0008
Matching Cylinder	S1036	S1246	S1552	S1875	S2091	S2091

## CHUCK SPECIFICATIONS

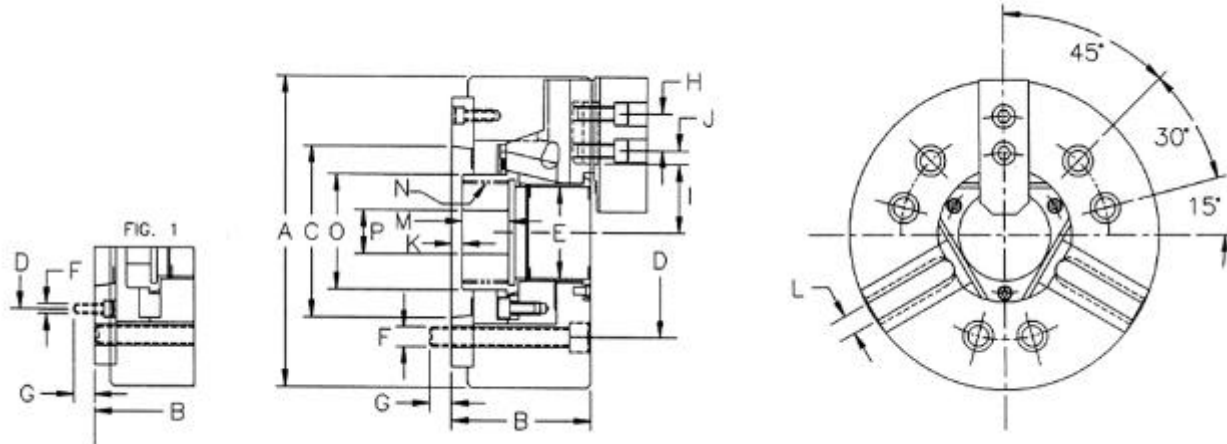

Call Us Or Visit Our Website For Our Complete Selection!