

JAW BORING TOOLS

JAW BORING RINGS

No need to look all over the shop for a setup piece and waste time. Our jaw boring ring is essential for boring soft jaws and round jaws.

FEATURES:

- Ideal for machining soft jaws.
- Attaches quickly without tools.
- Applies equal pressure on all jaws.
- Attaches to front of jaws, compensating for "jaw lift."
- Since no discs or bungs are used to clamp jaws, through boring of jaws is possible.



Save Set-Up Time!

How to install:

1. Place the jaw boring ring over your chuck and locate the boring ring pins in the counterbore of your chuck jaws.
2. Turn the jaw boring ring until snug.
3. Activate your jaws.

The jaw boring ring will apply equal pressure on all jaws, allowing for a consistent bore.



E

Jaw Boring Ring (comes complete with 3 pin assemblies)

Chuck Dia	ID Inch	OD Inch	Pin Depth	Pin Dia	Part Number	Price Each
6"	3.250	6.825	0.350"	0.512"	JBR-06	\$170.60
8"	3.500	8.450	0.350"	0.562"	JBR-08	\$209.70
10"	5.900	10.150	0.350"	0.709"	JBR-10	\$236.73
12"	7.475	12.075	0.400"	0.709"	JBR-12	\$263.18
15"	8.900	15.230	0.600"	0.938"	JBR-15	\$395.43

Extra Pin Assemblies

Pin Depth Inch	Pin Dia. Inch	Indiv. Pins Part Number	Price Each	Pins-Set of 3 Part Number	Price Each
0.350"	0.512"	JBR-PIN-06	\$21.83	JBR-PIN-06-SET3	\$65.48
0.350"	0.562"	JBR-PIN-08	\$21.83	JBR-PIN-08-SET3	\$65.48
0.350"	0.709"	JBR-PIN-10	\$21.83	JBR-PIN-10-SET3	\$65.48
0.400"	0.709"	JBR-PIN-12	\$21.83	JBR-PIN-12-SET3	\$65.48
0.600"	0.938"	JBR-PIN-15	\$21.83	JBR-PIN-15-SET3	\$65.48

Additional Pin Diameters Available. Please Call For More Information.

BORING STARS



FEATURES:

- Save set-up time
- Obtain any diameter easily and quickly.
- Reduces soft jaw costs
- Allows straight through boring of soft jaws.

Description	Part Number	Set Price
Jaw Boring Stars-Set of 4	JBT-100	\$27.00



D

ANTI-BACKLASH RING SET



A valuable time saver for your lathes and turning centers! Every ring you will ever need for boring out your soft jaws on one convenient wooden rack.

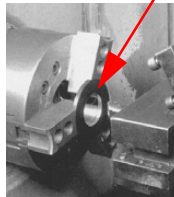

Size	Description	Part Number	Price Each
Standard Set	48 Rings, 1" to 3 15/16" in 1/16 increments	AI-220-00	\$283.48
Short Stack	16 Rings, 1" to 1 15/16" in 1/16 increments	AI-220-10	\$82.26



C

TRU JAWS CHUCK ADAPTERS

Remachine Soft Top Jaws on Power & Manual chucks in 60 Seconds! Replaces thousands of rings and spiders. Designed for use with 3 jaw power chucks.

FEATURES:

- OD and ID soft jaw remachining.
- Perfect concentricity & squareness of jaws.
- Maximum rigidity of jaws.
- Minimum stock removal.

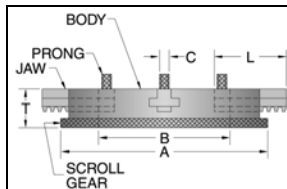

Thick T	Weight lbs	Prong Dia C	Max. Boring Range B	Min. Outside Range A	Jaw Length L	Chuck Range	Max Load Cap. lbs	Max RPM	Part Number	Price
1.25	12	0.50	3.250	6.125	3.00	up to 8"	8000	900	DN03540	\$890.36
1.75	28	0.75	6.625	10.625	4.75	8-14"	20000	600	DN03542	\$1,273.69
1.75	43	0.75	11.500	16.000	4.75	14-26"	15000	250	DN03544	\$2,472.47

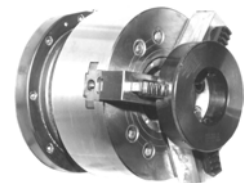

B

CNC SPINDLE WORKSTOP

FEATURES:

- For use in chucks, collets and rotary tables
- Reduce setup time, down time and operation costs
- Maximize repeatability, efficiency and profitability
- Operate with CNC turning/machine centers and manual machines
- Additional sizes available



Range (in)	Part Number	Price Each
1-1/4" - 1-5/8"	DN48052	\$306.00
1-5/8" - 2-1/16"	DN48053	\$362.92
2" - 2-7/16"	DN48054	\$384.78

B

Call Us Today For All Of Your Machine Tool Needs!

2010-11 Master Catalog

LATHE & CHUCK STOPS

CNC LATHE STOPS

The Accu-Stop Assembly is constructed of low carbon steel coated with zinc oxide for lasting strength and durability. The faceplate of the assembly mounts to the front of a draw tube style manual or power chuck, while the extension tubes extend back into the draw tube to accommodate work pieces of any length. The Accu-Stop bolts to the front of the chuck, allowing your work piece and the stop to turn together, eliminating friction damage. Easily pays for itself in just a few jobs by eliminating the time it takes to use the turret to locate your work piece!

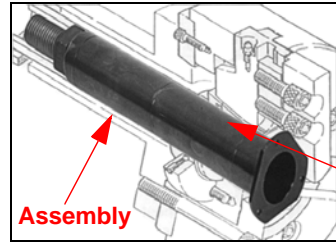

Designed to replace the inaccurate, extremely expensive stopping mechanisms that are being used in metal lathes all over the world.

Length adjustable by adding or removing tube section & adjusting rod.

Heavy Duty & High Accuracy!

Assembly includes:

Face Plate, Sub Face Plate, Three Extension Tubes, End Cap, Lock Nut and Threaded Adjustment Rod



BEST BUY!!
Save Money
When you Buy
the Accu-Stop
Package!

PACKAGE INCLUDES:
Complete Assembly, Accu-Stop
Special Vise & Strap Wrench

Accu-Stop

The Most Precise, Easy to Use and Inexpensive Stop for CNC Lathes!

*Ensures Accuracy/
Repeatability within .0005"!*

*Comes Fully
Assembled!*

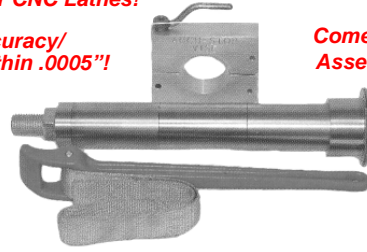

Chuck Size	Description	Part Number	Price Each
6"	Accu-Stop Assembly 16.5"	AS-1000	\$436.10
	Package - Deluxe	AS-P1000	\$637.00
	Extra Tube (5" Long)	AS-1003	\$48.02
	Tubing stop option*	AS-TSO1000	\$53.90
8"	Accu-Stop Assembly 16.5"	AS-2000	\$436.10
	Package - Deluxe	AS-P2000	\$637.00
	Extra Tube (5" Long)	AS-2003	\$48.02
	Tubing stop option*	AS-TSO2000	\$53.90
10"	Accu-Stop Assembly 16.5"	AS-3000	\$485.10
	Package - Deluxe	AS-P3000	\$686.00
	Extra Tube (5" Long)	AS-3003	\$53.90
	Tubing stop option*	AS-TSO3000	\$63.70
12"	Accu-Stop Assembly 20.25"	AS-4000	\$730.10
	Package - Deluxe	AS-P4000	\$931.00
	Extra Tube (6" Long)	AS-4003	\$80.36
	Tubing stop option*	AS-TSO4000	\$73.50

*If machining tubing, you may need the tubing stop option

ORDERING INFORMATION:

Please have the following available when placing order:

1. Make/Model of lathe
2. Date manufactured
3. Make/Model of chuck
4. Inside diameter of the draw tube.

LATHE CHUCKS
LIVE CENTERS

VICE JAWS
VICE ACCESSORIES

STRAIGHT SHANK
COLLET HOLDERS

LATHE BUSHINGS
DRILL CHUCKS

CARBIDE INSERTS
THREADING/GROOVING

CUTTING TOOLS
MACHINERY

PRECISION TOOLS
DEBURRING

COOLANT/FLUIDS
TOOL STORAGE

D

C

CHUCK STOPS

This product is so useful and simple, you'll wonder why you never thought of it. The Royal chuck stop is a precision machined aluminum extrusion which mounts squarely against the face of almost any 3 jaw lathe chuck, providing a fixed reference surface for workpieces to locate against.

Accommodates Chuck Jaws Up To 2 1/8" Wide!



FEATURES:

- Allows short parts to project past the chuck jaws, providing clearance for facing operations.
- Eliminates the need to bore soft jaws, reducing setup time.
- Front and rear locating surfaces are parallel within $\pm 0.0004"$.
- 25mm slot width can be milled larger for chucks with wider jaws.
- Interlocking design coupled with three strong magnets holds stop securely in place-much safer than using parallels which can be thrown out by centrifugal force.
- Anodized aluminum finish provides good wear-resistance.



*Easily locate short parts
in a 3-Jaw Chuck!*



ROYAL
PRODUCTS

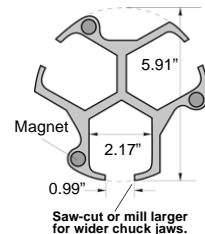

Description	Part Number	Set Price
Standard Set: 15, 20 & 25mm stops	ROY-25200	\$199.92
Deluxe Set: 15, 20, 25, 30 & 35mm stops	ROY-25210	\$347.90

Call Us Or Visit Our Website For Our Complete Selection!

2010-11 Master Catalog

11