

ROUND JAWS- SQUARE SERRATED KEY TYPE

FOR USE ON: **S.P., Pratt Burnerd, Warner & Swasey & Other Chucks**

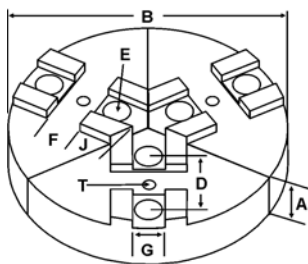

- Square Serrated Key Type
- Round Jaws allow for complete gripping of workpiece
- Oversized jaws available
- Ideal for thin-walled or irregular shaped workpieces.
- Can be machined to fit workpiece
- All jaws have 2 holes
- Special "J" dimensions available
- Available in Aluminum & Cast Iron
- **Made in the USA**

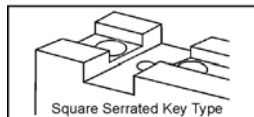

Group No.	Chuck Size	Tap Hole T	Key to Front J	Critical Dimensions				Pie Dia B	Hght Inch A	ALUMINUM		CAST IRON		STEEL		
				Groove Width G	Key Width F	Screw Size E	Hole Space D			Part Number	Price Set Of 3	Part Number	Price Set Of 3	Part Number	Price Set Of 3	
SI-07-5/16-16	6	NONE	1.40	0.738	0.377	5/16	1.688	6	2.00	RSP-6200A*	64.00	RSP-6200CI*	89.60	-	-	
								8	2.00	8-RSP-6200A*	91.50	-	-	-	-	
								4.00	RSP-6400A*	108.34	RSP-6400CI*	153.59	-	-	-	-
SI-05-3/8-14	8	1/4-20	2.00	0.501	0.745	3/8	1.438	8	2.00	RSP-8200A	103.98	RSP-8200CI	115.20	-	-	
								4.00	RSP-8400A	145.57	RSP-8400CI	217.59	-	-	-	-
								12	2.00	12-RSP-8200A*	177.32	-	-	-	-	-
SI-06-1/2-12	8	10-32	2.00	0.670	0.601	1/2	1.250	8	2.00	-	-	RSP-8202CI	115.20	-	-	
SI-07-1/2-14	8	1/4-20	2.00	0.751	0.745	1/2	1.438	8	2.00	RSP-8205A	103.98	RSP-8205CI	115.20	-	-	
SI-07-1/2-17	10 to 12	5/16-18	2.50	0.751	0.994	1/2	1.750	10	2.00	RSP-10200A	136.45	RSP-10200CI	172.80	RSP-10200S	338.55	
								4.00	RSP-10400A	210.47	RSP-10400CI	307.19	-	-		
								12	2.00	RSP-12200A	177.32	RSP-12200CI	255.99	-	-	
SI-07-5/8-17	10 to 12	5/16-18	3.75	0.751	0.994	5/8	1.750	12	2.00	RSP-12205A	177.32	RSP-12205CI	255.99	-	-	
								4.00	RSP-12405A	351.92	-	-	-	-		
								15	4.00	15-RSP-12405A	448.37	-	-	-	-	
SI-10-3/4-25	15 to 18	3/8-16	4.00	1.001	1.488	3/4	2.500	12	2.00	12-RSP-15200A	177.32	-	-	-	-	
								15	2.50	RSP-15250A	366.98	-	-	-	-	
								4.00	RSP-15400A	483.52	-	-	-	-		

Round Jaw Material: ALUMINUM-6061-T6 Bar Stock, CAST IRON-Gray, STEEL-1018. 18" & Larger- Aluminum Casting T6
For complete list of applicable chucks, see pages 632-644. * denotes non-stock item. Please allow 1 week manufacturing time.

HARD JAWS SQUARE KEY SERRATED



- FEATURES:**
- Designed for first operation roughing, expect standard runout between **0.005-0.010**
 - Reversible-suitable for OD & ID workholding.
 - **XTRA BITE** -very aggressive bite. Has conical teeth for extra gripping power and ground body to provide improved runout.

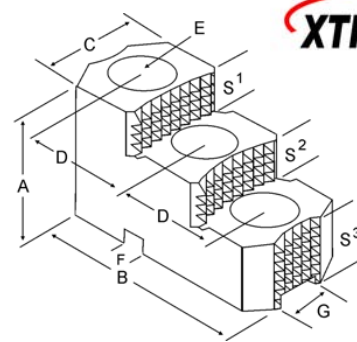

GROUP	Chuck Size	Critical Dimensions										Part Number	Price Per Set			
		Groove Width G	Tongue Width F	Screw Size E	Hole Space D	Tap Hole	Width Inch C	OAL Inch B	Height Inch A	No. of Holes	No. of Steps			Top Step Ht S1	Mid Step Ht S2	Bot Step Ht S3
SI-07-1/2-17	12	0.750	0.994	1/2	1.750	5/16-18	1.750	4.875	2.469	2	2	0.650	0.650	1.169	SP-120HJ2-X	\$586.76
SI-07-5/8-17	12	0.750	0.994	5/8	1.750	5/16-18	1.750	4.875	2.469	2	2	0.650	0.650	1.169	SP-125HJ2-X	\$586.76
SI-10-3/4-25	15 & UP	1.000	1.488	3/4	2.500	3/8-16	2.500	5.500	3.469	2	2	0.950	0.950	1.569	SP-150HJ2-X	\$838.24

COLLET PADS TOP JAWS & COLLET PADS



Please See Pages 80-83 For More Information!

TOP JAW FEATURES:

- Top Jaws available for many popular power chucks
- Collet pad top jaws can help to convert your CNC lathe chuck into a precision bar machine
- Made in the USA!

COLLET PAD FEATURES:

- Warner & Swasey
- "S" Style
- Serrated, Square, Hexes & Emergency Pads
- Made in the USA!

Call Us Today For All Of Your Machine Tool Needs!

SOFT JAWS- SQUARE SERRATED KEY TYPE

C

LATHE CHUCKS
LIVE CENTERS

WISE JAWS
WISE ACCESSORIES

STRAIGHT SHANK
COLLET HOLDERS

LATHE BUSHINGS
DRILL CHUCKS

CARBIDE INSERTS
THREADING/GROOVING

CUTTING TOOLS
MACHINERY

PRECISION TOOLS
DEBURRING

COOLANT/FLUIDS
TOOL STORAGE

FOR USE ON: **Buck & Bison 6" Chucks, S.P., Pratt Burnerd & Other Chucks**

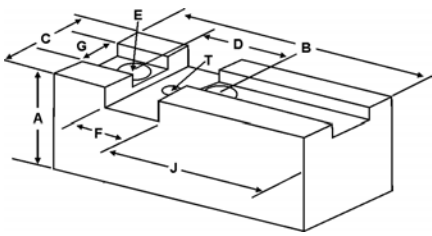

- Supplies maximum concentricity on finish turning operations
- Can be bored or turned to fit workpiece
- Steel jaws can be hardened
- Available flat ended or pointed for smaller diameter parts
- Special orders available
- Available in Aluminum, Steel & Aircraft Aluminum (where noted)
- **Made in the USA**

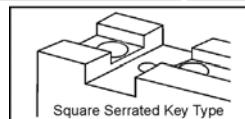
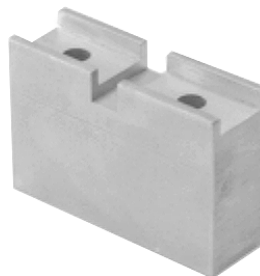

QUANTITY DISCOUNTS!
Order **5 SETS OR MORE** of the same part number soft jaw and receive a **5% DISCOUNT!**

Group No.	Chuck Size	Tap Hole T	Key to Front J	Critical Dimensions				Width Inch C	Length Inch B	Hght Inch A	ALUMINUM		STEEL	
				Groove Width G	Key Width F	Screw Size E	Hole Space D				FLAT END Part Number	Price Set Of 3	FLAT END Part Number	Price Set Of 3
SI-07-5/16-16	6	NONE	1.500	0.738	0.377	5/16	1.688	1.00	3.00	1.50	SP-6150AF	\$34.25	SP-6150F	\$34.25
										2.00	SP-6200AF	\$51.20	SP-6200F	\$55.12
										2.50	SP-6250AF	\$43.75	SP-6250F	\$44.27
										4.00	SP-6400AF	\$79.99	SP-6400F	\$86.79
SI-05-3/8-14	8	1/4-20	1.250	0.501	0.745	3/8	1.438	1.25	3.00	2.00	SP-8200AF	\$47.07	SP-8200F	\$50.52
										3.00	SP-8300AF	\$57.20	SP-8300F	\$61.24
SI-06-1/2-12	8	10-32	2.000	0.670	0.601	1/2	1.250	1.50	3.75	2.00	SP-8202AF	\$50.27	SP-8202F	\$53.74
										3.00	SP-8302AF	\$61.07	SP-8302F	\$66.25
SI-07-1/2-14	8	1/4-20	1.875	0.751	0.745	1/2	1.438	1.50	3.50	2.00	SP-8205AF	\$57.12	SP-8205F	\$61.24
									3.00	SP-8305AF	\$53.76	SP-8305F	\$58.33	
									3.375	4.00	SP-8405AF*	\$84.66	SP-8405F*	\$91.85
SI-07-1/2-17	10 to 12	5/16-18	1.625	0.751	0.994	1/2	1.750	1.75	4.00	2.50	SP-10250AF	\$53.37	SP-10250F	\$56.64
									4.00	SP-10400AF	\$75.23	SP-10400F	\$79.60	
									2.50	SP-12250AF	\$56.42	SP-12250F	\$59.72	
									4.00	SP-12400AF	\$86.87	SP-12400F	\$91.85	
SI-07-5/8-17	10 to 12	5/16-18	2.000	0.751	0.994	5/8	1.750	1.75	5.50	2.50	SP-12256AF	\$63.33	SP-12256F	\$66.99
									5.50	2.50	SP-12257AF	\$63.33	SP-12257F	\$66.99
									2.50	SP-12255AF	\$56.42	SP-12255F	\$59.72	
									4.00	SP-12405AF	\$86.87	SP-12405F	\$91.85	
SI-10-3/4-25	15 to 18	3/8-16	3.250	1.001	1.488	3/4	2.500	2.50	6.25	2.50	SP-15250AF	\$80.20	SP-15250F	\$84.19
									3.00	SP-15300AF	\$122.76	SP-15300F	\$133.18	
									4.00	SP-15400AF	\$110.00	SP-15400F	\$138.37	
									4.00	SP-15403AF*	\$149.25	SP-15403F	\$161.92	
									2.50	SP-15253AF*	\$108.55	SP-15253F*	\$117.76	
SI-10-3/4-30	20 - 24	3/8-16	3.250	1.001	1.488	3/4	3.000	2.50	6.25	2.50	SP-20250AF*	\$80.20	SP-20250F*	\$84.19
									4.50	SP-20400AF	\$110.50	SP-20400F	\$114.82	

For "Pointed" Soft Jaws, please substitute "P" for "F" in the part number. Example: SP-8200AF will be SP-8200AP. Pointed Jaws: Up to 10" add \$3.25, 12" & over add \$6.50.
Soft Jaw Material: ALUMINUM-6061-T6 Bar Stock, STEEL-1018, "B" JAWS-7075-T6 Aircraft Aluminum
For complete list of applicable chucks, see pages 632-644. * denotes non-stock item. Please allow 1 week manufacturing time.

MASTER KEYS

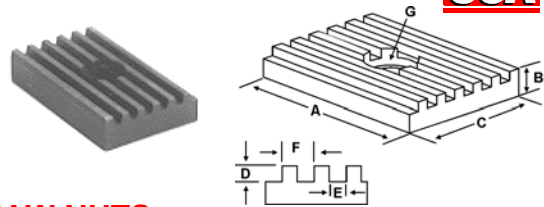

Chuck Size	Critical Dimensions					Width Inch C	Hght Inch B	Length Inch A	Master Key Part Number	Price Each
	Screw Size G	Pitch F	Slot E	Depth D	Depth D					
8	1/4	0.200	0.098	0.101	0.744	0.375	1.313	SP-80SQK	\$25.24	
8-SP	1/4	0.155	0.075	0.101	0.744	0.435	1.406	SP-8CCAK	\$25.24	
10 - 12	5/16	0.250	0.124	0.130	.993	0.500	1.688	SP-120SQK	\$28.04	
15 - 18	3/8	0.250	0.124	0.130	1.487	0.500	2.000	SP-150SQK	\$31.54	
15 - 18	3/8	0.250	0.124	0.130	1.487	0.500	2.250	SP-180SQK	\$32.25	
20 - 24	3/8	0.250	0.124	0.130	1.487	0.500	2.500	SP-210SQK	\$35.05	

JAW NUTS

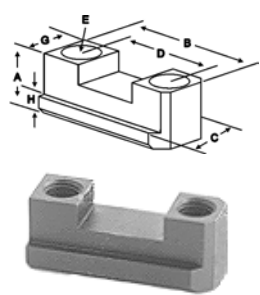

Chuck Size	Critical Dimensions						2 Screws Included With Each Jaw Nut				
	Heel Height H	Groove Width G	Screw Size E	Hole Space D	Hght Inch A	Width Inch C	Length Inch B	Jaw Nut Part Number	Price Each	Screw Part Number	Price Each
8	0.375	0.498	3/8-16	1.438	0.995	0.875	2.125	SP-80JN	\$50.05	S3/816100	\$2.00
8	0.375	0.748	1/2-13	1.438	0.995	0.993	2.125	SP-85JN	\$50.05	S1/213150	\$2.00
10 - 12	0.375	0.748	1/2-13	1.750	1.000	1.000	2.438	SP-100JN	\$47.12	S1/213150	\$2.00
10 - 12	0.375	0.748	5/8-11	1.750	1.000	1.000	2.500	SP-125JN	\$47.12	S5/811150	\$3.00
15 - 18	0.438	1.000	3/4-10	2.500	1.250	1.250	3.750	SP-155JN	\$51.54	S3/410175	\$4.00
20 - 24	0.438	1.000	3/4-10	3.000	1.250	1.250	4.500	SP-215JN	\$54.47	S3/410175	\$4.00

Call Us Or Visit Our Website For Our Complete Selection!

2010-11 Master Catalog

53